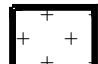
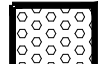

FINISH LEGEND

-  CARPET - REFER TO SPECIFICATIONS FOR PATTERN AND COLOR
-  RUBBER TACTILE FLOORING - REFER TO SPECIFICATIONS FOR PATTERN AND COLOR

FINISH PLAN REFERENCED NOTES

1. EXISTING STAIRS THREAD FINISH TO REMAIN.

NOTE:
CONTRACTOR TO VERIFY CONDITIONS AT EACH TRANSITION AND SIZE REDUCERS ACCORDINGLY.

FINISH PLAN GENERAL NOTES

1. REFER TO SHEET A9.50 FOR ROOM FINISH SCHEDULES AND ADDITIONAL NOTES/SCOPE.
2. REFER TO SPECIFICATIONS FOR ADDITIONAL PRODUCT INFORMATION.
3. MAKE EXISTING FLOOR SLAB SMOOTH AND FLAT TO FLOOR FINISH MANUFACTURER'S TOLERANCE WITH MATERIAL SUITABLE TO FLOOR FINISH.
4. ALL TRANSITIONS BETWEEN DISSIMILAR FLOORING MATERIALS ARE TO RECEIVE A NEW TRANSITION STRIP - REFER TO DETAILS 2/A9.10.
5. PROVIDE WALL BASE AT ALL LOCATIONS OF NEW FLOORING AND/OR NEW WALL CONSTRUCTION - UNLESS NOTED OTHERWISE.
6. CARPETED AREAS ARE TO RECEIVE RUBBER STRAIGHT BASE.
7. AT AREAS WHERE PATCHING OF WALL BASE IS REQUIRED - FINISH TO MATCH ADJACENT IN MATERIAL, COLOR, HEIGHT, FINISH AND PROFILE.
8. DO NOT PAINT PRE-FINISHED ITEMS, FACE BRICK, AND TILE FINISHES.
9. AT ALL DOORS AND FRAMES INSTALLED IN EXISTING OPENINGS - PATCH AND PAINT EXISTING WALL, JAMB AND HEAD SURFACES AFTER FRAME INSTALLATION - DO NOT PAINT PRE-FINISHED ITEMS - MATCH EXISTING COLOR, UNLESS NOTED OTHERWISE.
10. AT ALL AREAS WHERE MECHANICAL EQUIPMENT HAS BEEN REMOVED - PATCH AND PAINT EXISTING EXPOSED CONSTRUCTION - MATCH ADJACENT EXISTING CONSTRUCTION IN MATERIAL, TEXTURE, SIZE, FINISH AND COLOR.
11. FLOOR FINISH AT LIFT TO BE PROVIDED BY LIFT MANUFACTURER.
12. TRANSITION STRIP BETWEEN LIFT AND FLOORING PROVIDED BY LIFT MANUFACTURER.

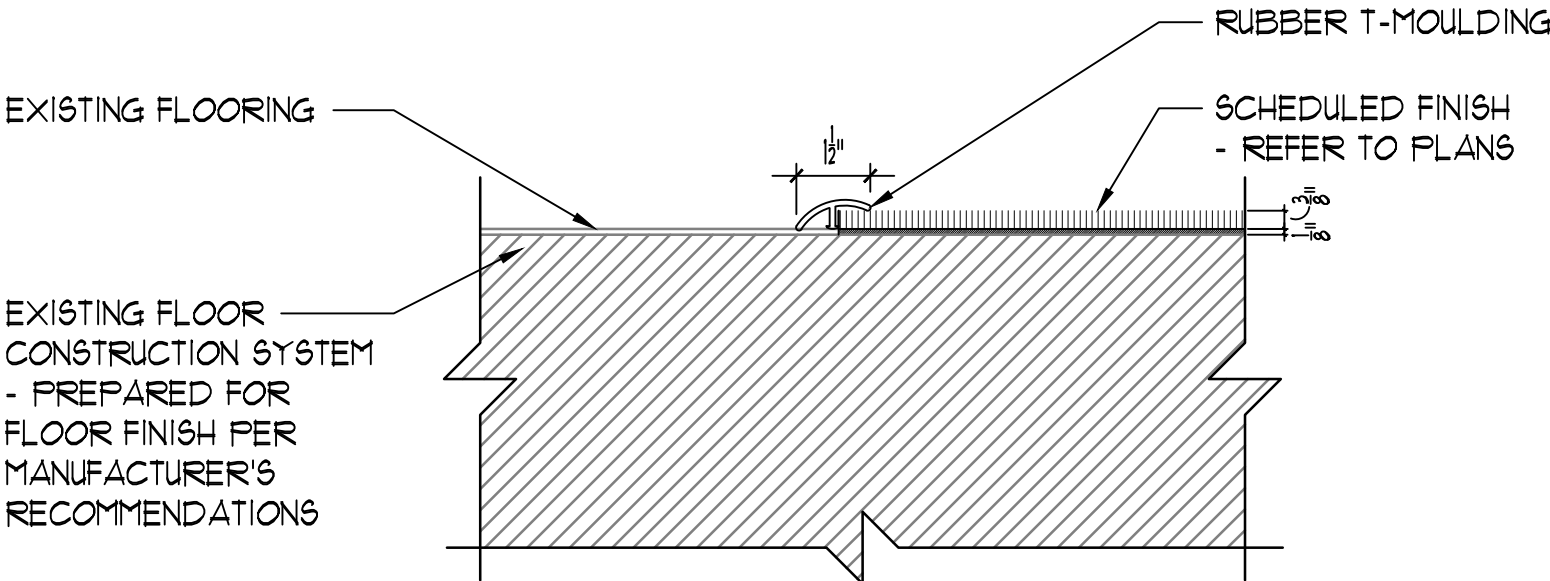

2 TI - TRANSITION DETAIL
3" = 1'-0"

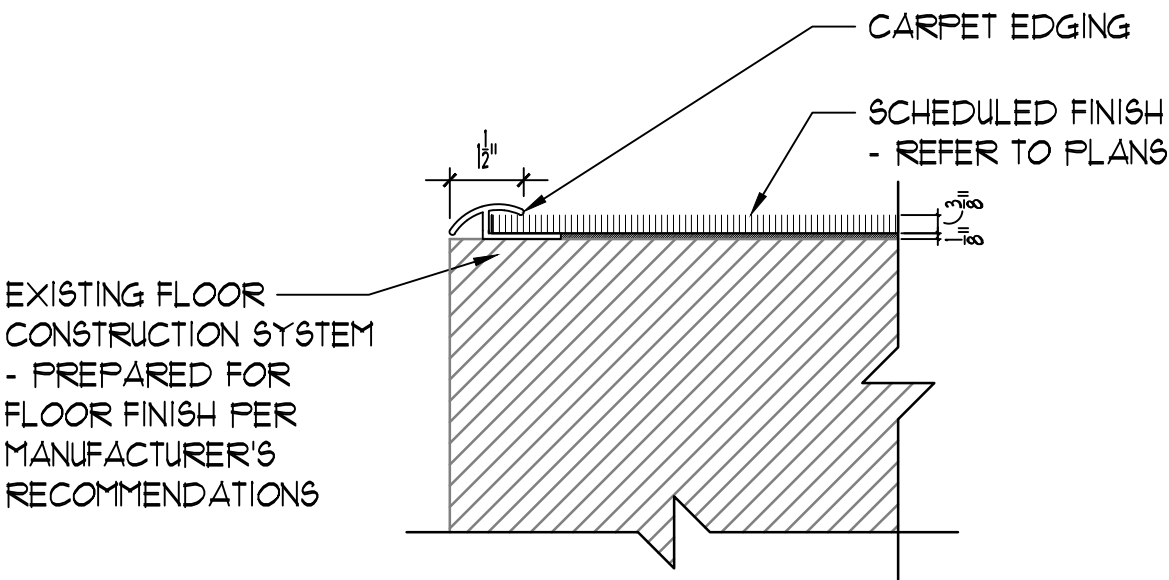

3 SECTION DETAIL
3" = 1'-0"

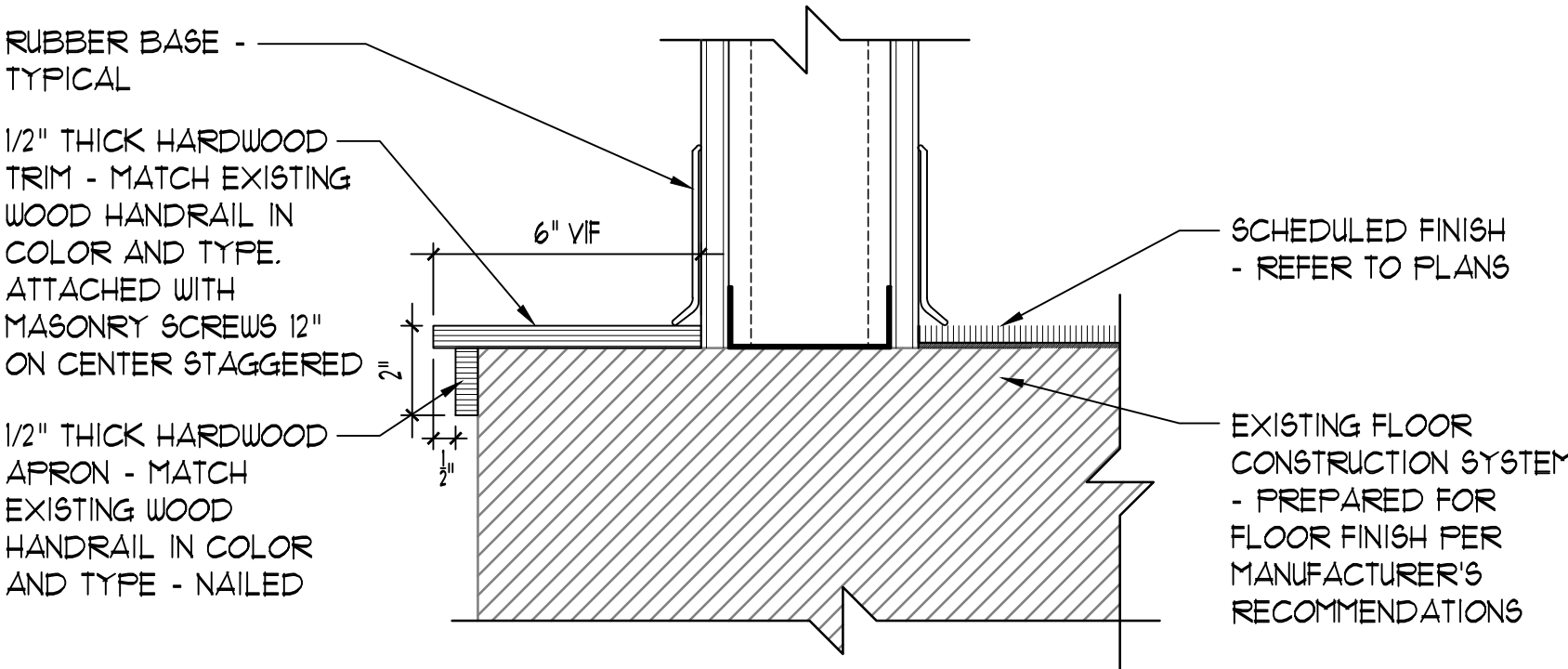

4 SECTION DETAIL
3" = 1'-0"

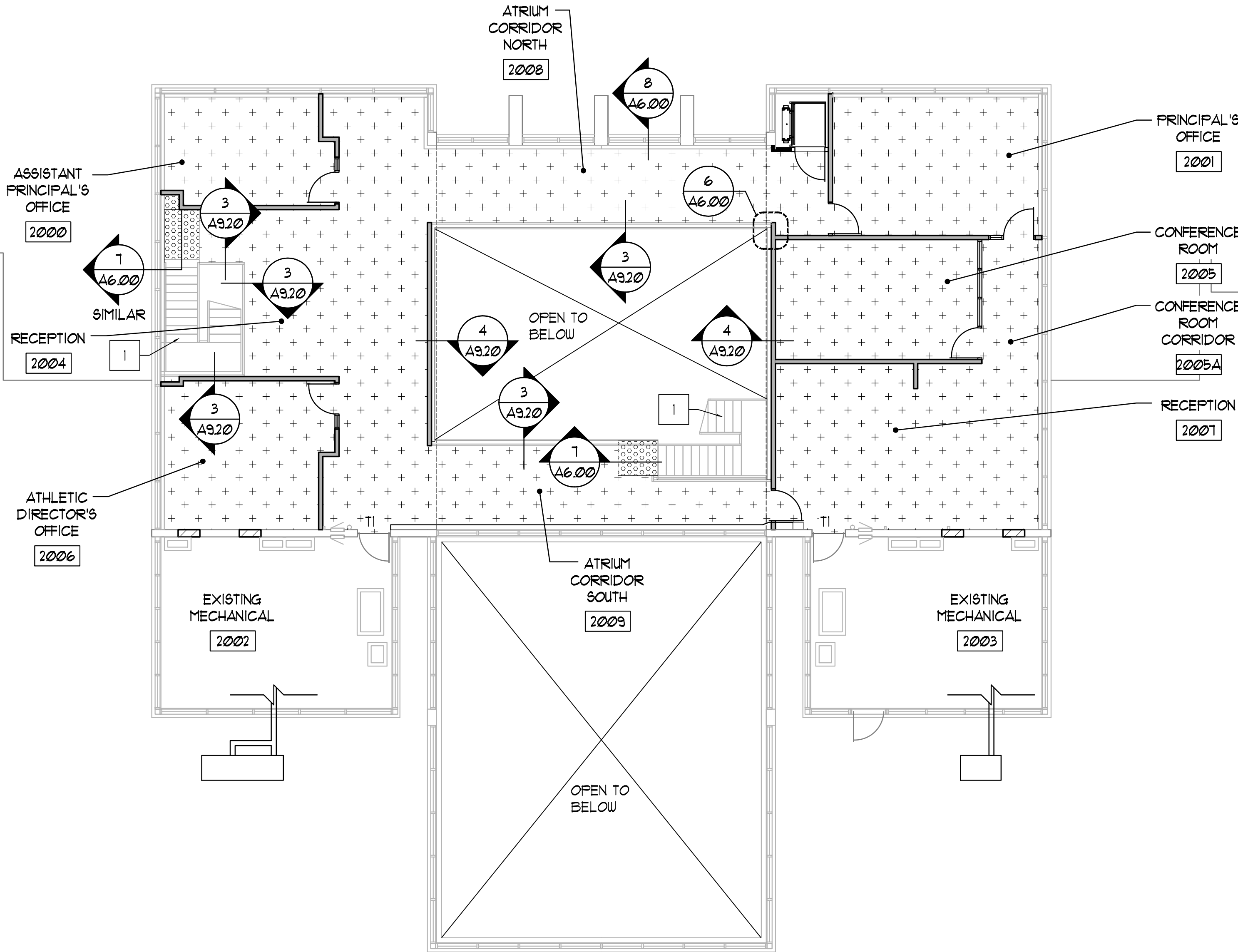

1 PARTIAL SECOND FLOOR FINISH PLAN
1/8" = 1'-0"

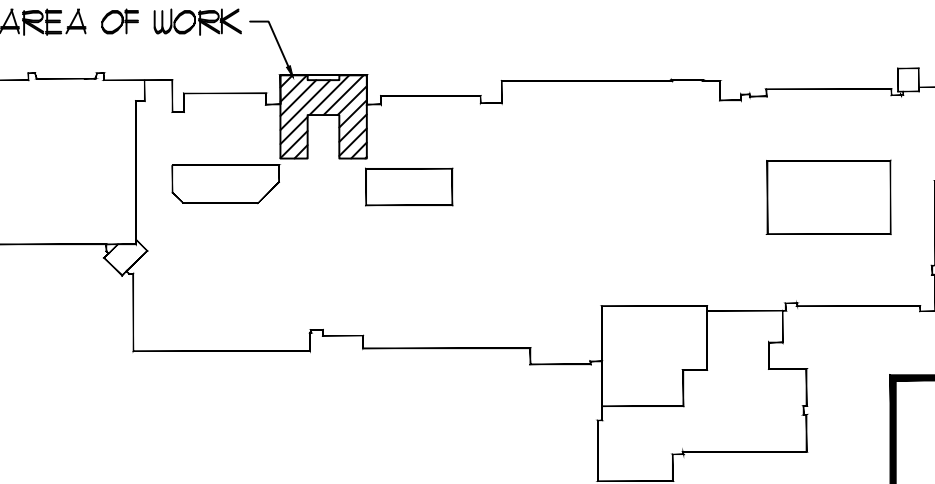
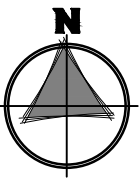

KEY PLAN
NOT TO SCALE

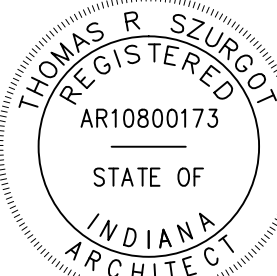
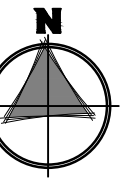

DUNELAND SCHOOL CORPORATION
2018 MAIN OFFICE RENOVATIONS AT:
CHESTERTON MIDDLE SCHOOL (CMS)
651 W. MORGAN AVENUE, CHESTERTON, INDIANA 46304

PROJECT NUMBER:	A-003
PROJECT MANAGER:	MS
DRAWN BY:	PS
DATE FOR BID:	07/22/2018
PARTIAL SECOND FLOOR FINISH PLAN	

A9.20

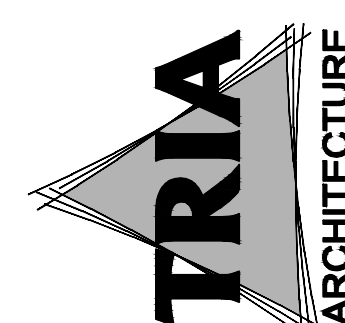

TRIA
ARCHITECTURE

PROJECT CONSULTANT:
OAS, LLC
CHICAGO, IL 60601
789 KATELAND DR. UNIT 1, STATE BEACH, INDIANA 46584

STRUCTURAL ENGINEER:
GreenbergFarrow
21 SOUTH DEWEY DRIVE, 2ND FLOOR
MICHIGAN, MI 48106