

- PLAN NOTES:
1. EXHAUST FAN TO BE CONNECTED TO AND CONTROLLED BY LIGHTING CIRCUIT.
 2. CONNECT NEW LIGHT FIXTURE TO EXISTING LIGHTING CIRCUIT.
 3. EXHAUST FAN TO BE CONNECTED TO EXISTING LIGHTING CIRCUIT, APPROXIMATELY THIRTY TWO (32) FEET NORTH OF JAN/HVAC ROOM.
 4. CONNECT TO EXISTING EXTERIOR LIGHT CIRCUIT IN EXISTING PANEL LOCATED IN MECHANICAL ROOM.
 5. CENTER GAZE LIGHTS ON PARKING AREA. LOCATE 3' AND GRASS. CONNECT TO SPARE 200V CIRCUIT BREAKER IN EXISTING PANEL.
 6. CONNECT TO UNSWITCHED LEG OF LIGHTING CIRCUIT INDICATED.

LIGHTING FLOOR PLAN

1/4" = 1'-0"

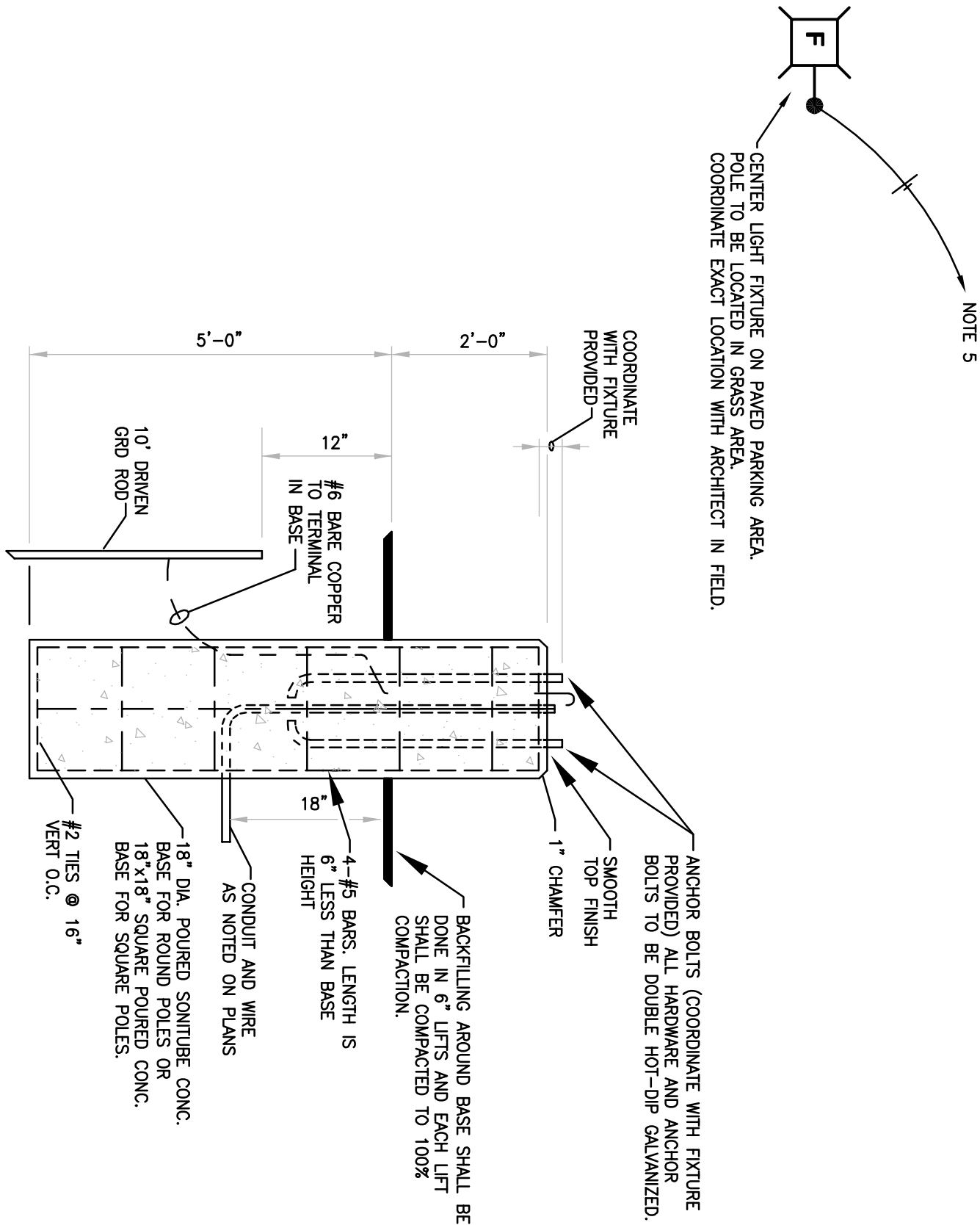
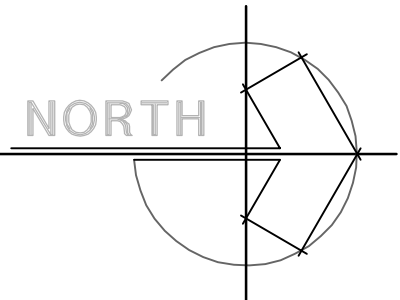

AREA LIGHTING POLE
BASE DETAIL
NOT TO SCALE