

1 FLOOR PLAN UNIT "J"
SCALE: 1/8"=1'-0"
SECOND FLOOR

KEY PLAN

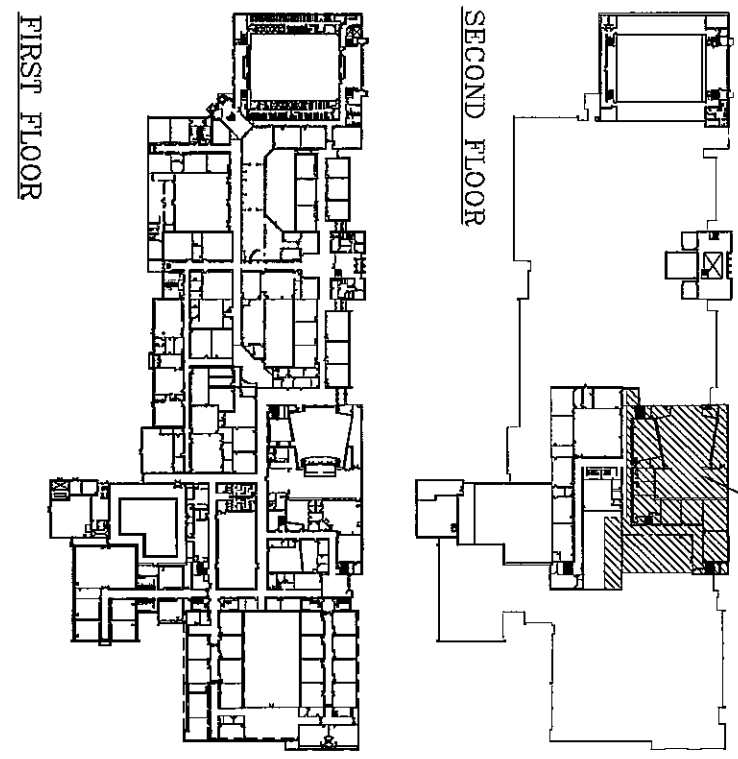

SYMBOLS/LEGEND

1. ROUTE COAX CABLES (FENIX RC-6 TYPE) TO EQUIPMENT ROOM (ER), TERMINATE BOTH ENDS AND TEST.

2. ROUTE POWER CABLE (FENIX RC-6 TYPE) TO EQUIPMENT ROOM (ER) OR TELECOMMUNICATION ROOM (TR) AS SHOWN IN DRAWING S1 (1). OUTDOOR CABLES TO HAVE A SEPARATE POWER RUN FOR THE HEATER.

3. ROUTE DATA CABLE (RS-485) FOR OUTDOOR PAN/ZOOM CAMERAS PER UFG. REQUIREMENTS TO EQUIPMENT ROOM (ER) AS SHOWN IN DRAWING S1 (1).

4. ROUTE COAX AND POWER CABLES IN EXISTING TELECOMMUNICATION TRAYS WHERE POSSIBLE.

5. REFERENCED NOTES BELOW ARE NOT NECESSARILY USED ON EVERY DRAWING.

REFERENCED NOTES

1. EXISTING TRAY SYSTEM

2. INDOOR CAMERA, WV-CW1744F MOUNTED IN DROP CEILING, SEE DRAWING S1 (4).

3. INDOOR CAMERA, WV-224GF MOUNTED IN DROP CEILING, SEE DRAWING S1 (4).

4. INDOOR CAMERA, WV-CW1744F MOUNTED ON WALL, SEE DRAWING S1 (2).

5. INDOOR CAMERA, WV-CW24GF MOUNTED ON WALL, SEE DRAWING S1 (2).

6. OUTDOOR FISH EYE CAMERA, WV-CW1744F MOUNTED AS SHOWN ON DRAWING S1 (6).

7. OUTDOOR PAN & TILT/ZOOM CAMERA, WV-CW-8844 MOUNTED AS SHOWN ON DRAWING S1 (2).

REVISIONS/DATE
1. 11/16/05 AS-BUILDS

DUNELAND SCHOOL CORPORATION
CHESTERTON MIDDLE SCHOOL
CHESTERTON, INDIANA
CCTV SYSTEM

PROJECT: 04-1033
DRAWN BY: RJJ
CHECKED BY: LMD
SCALE: 1/8"=1'-0"
DATE: 04.28.2005

DSA, Inc.
Technology Design Consultants
16618 East 196 th Street
Noblesville IN 46060-9530
(765) 534-5152

DRAWING NUMBER
T3.1