

1 FLOOR PLAN - UNIT "C"  
727 SCALE: 1/8"=1'-0"

FIRST FLOOR

KEY PLAN

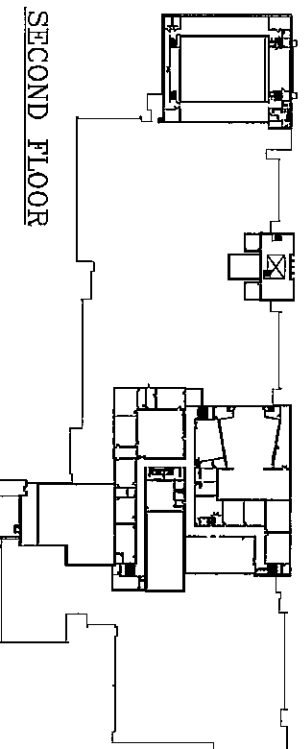

SECOND FLOOR

FIRST FLOOR

UNIT "C"



- SYMBOLS/LEGEND**
- 727 OF # - CAMERA IDENTIFICATION NUMBER**
- GENERAL NOTES**
1. ROUTE COAX CABLES (GENIUM RG-6 TYPE) TO EQUIPMENT ROOM (ER), TERMINATE BOTH ENDS AND TEST.
  2. ROUTE POWER CABLE (GENIUM SEE PER UFG REQUIREMENTS) TO EQUIPMENT ROOM (ER) OR TELECOMMUNICATION ROOM (TR) AS SHOWN IN DRAWING 4.1 (1). OUTDOOR CAMERAS TO HAVE A SEPARATE POWER RUN FOR THE HEATER.
  3. ROUTE DATA CABLE (RS-485) FOR OUTDOOR PAN/TILT/ZOOM CAMERAS PER UFG REQUIREMENTS TO EQUIPMENT ROOM (ER) AS SHOWN IN DRAWING 4.1 (1).
  4. ROUTE COAX AND POWER CABLES IN EXISTING TELECOMMUNICATION TRAYS WHERE POSSIBLE.
  5. REFERENCED NOTES BELOW ARE NOT NECESSARILY USED ON EVERY DRAWING.
- REFERENCED NOTES**
1. EXISTING TRAY SYSTEM
  2. INDOOR CAMERA, WI-CW144F MOUNTED IN DROP CEILING, SEE DRAWING S.1 (4).
  3. INDOOR CAMERA, WI-224CF, MOUNTED IN DROP CEILING, SEE DRAWING S.1 (4).
  4. INDOOR CAMERA, WI-CW174S MOUNTED ON WALL, SEE DRAWING S.1 (3).
  5. INDOOR CAMERA, WI-CV224CF MOUNTED ON WALL, SEE DRAWING S.1 (3).
  6. OUTDOOR FIXED CAMERA, WI-CW174 MOUNTED AS SHOWN ON DRAWING S.1 (3).
  7. OUTDOOR PAN & TILT/ZOOM CAMERA, WI-CW-BS4A MOUNTED AS SHOWN ON DRAWING S.1 (2).

**DSA** Inc.  
Technology Design Consultants  
16618 East 196 th Street  
Noblesville IN 46060-9530  
(765) 534-5152

PROJECT. 04-1033  
DRAWN BY - RJJ  
CHECKED BY - LMD  
SCALE - 1/8"=1'-0"  
DATE : 04.28.2005

DUNELAND SCHOOL CORPORATION  
CHESTERTON MIDDLE SCHOOL  
CHESTERTON, INDIANA  
CCTV SYSTEM

REVISIONS/DATE  
1. 11/16/05 AS-BUILDS

DRAWING NUMBER

T 2.7