

1 FLOOR PLAN - UNIT "C"
T2.3 SCALE: 1/8"=1'-0"

FIRST FLOOR

KEY PLAN

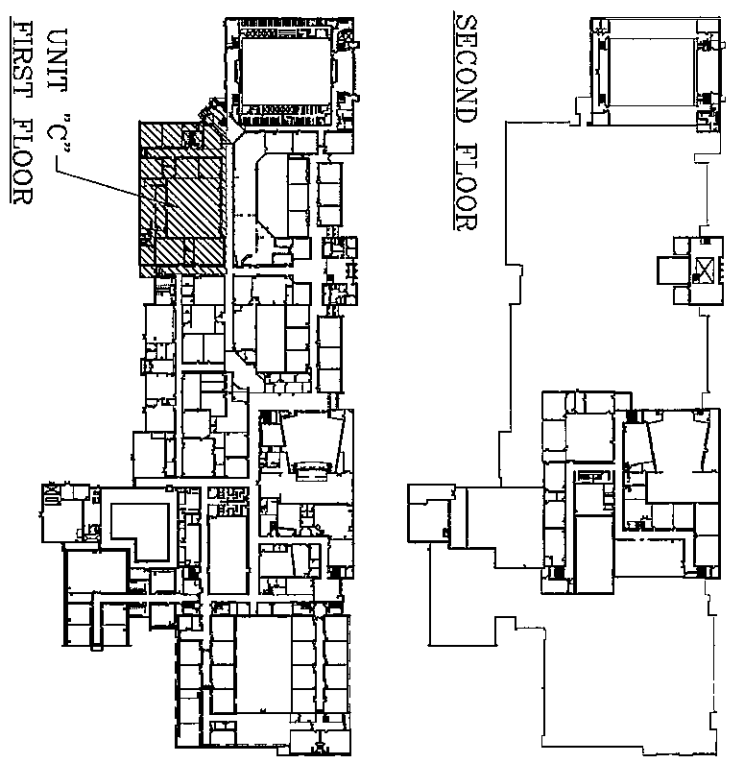

NORTH

SYMBOLS/LEGEND

1-12 - CAMERA IDENTIFICATION NUMBER

GENERAL NOTES

1. ROUTE COAX CABLES (PENNUN RC-6 TYPE) TO EQUIPMENT ROOM (ER). TERMINATE BOTH ENDS AND TEST.
2. ROUTE POWER CABLE (PENNUN SIZE PER MFG. REQUIREMENTS) TO EQUIPMENT ROOM (ER) OR TELECOMMUNICATION ROOM (TR) AS SHOWN IN DRAWING 4.1 (1) (9) OUTDOOR CAMERAS TO HAVE A SEPARATE POWER RUN FOR THE HEATER.
3. ROUTE DATA CABLE (RS-485) FOR OUTDOOR PAIR/ZOOM CAMERAS PER MFG. REQUIREMENTS TO EQUIPMENT ROOM (ER) AS SHOWN IN DRAWING 4.1 (1).
4. ROUTE COAX AND POWER CABLES IN EXISTING TELECOMMUNICATION TRAYS WHERE POSSIBLE.
5. RETROFitted NOTES BELOW ARE NOT NECESSARILY USED ON EVERY DRAWING.

REFERENCED NOTES

1. EXISTING TRAY SYSTEM
2. INDOOR CAMERA, W-CW4744F MOUNTED IN DROP CEILING. SEE DRAWING 5.1 (4).
3. INDOOR CAMERA, W-224G5, MOUNTED IN DROP CEILING. SEE DRAWING 5.1 (4).
4. INDOOR CAMERA, W-CW4744S MOUNTED ON WALL. SEE DRAWING 5.1 (3).
5. INDOOR CAMERA, W-CW24G7 MOUNTED ON WALL. SEE DRAWING 5.1 (3).
6. OUTDOOR PIRID CAMERA, W-CW374 MOUNTED AS SHOWN ON DRAWING 5.1 (6).
7. OUTDOOR PAIR & TILT/ZOOM CAMERA, W-CW-864A MOUNTED AS SHOWN ON DRAWING 5.1 (3).

REVISIONS/DATE
1. 11/16/05 AS-BUILDS

DUNELAND SCHOOL CORPORATION
CHESTERTON MIDDLE SCHOOL
CHESTERTON, INDIANA
CCTV SYSTEM

PROJECT: 04-1033
DRAWN BY: RJJ
CHECKED BY: LMD
SCALE: 1/8"=1'-0"
DATE: 04.28.2005

DSA Inc.
Technology Design Consultants
16618 East 196 th Street
Noblesville IN 46060-9530
(765) 534-5152

DRAWING NUMBER

T2.3

2005-12-05