

1 OVERALL LAYOUT
T1.2 / SCALE: 1/32"=1'-0" SECOND FLOOR

KEY PLAN
UNIT "K"

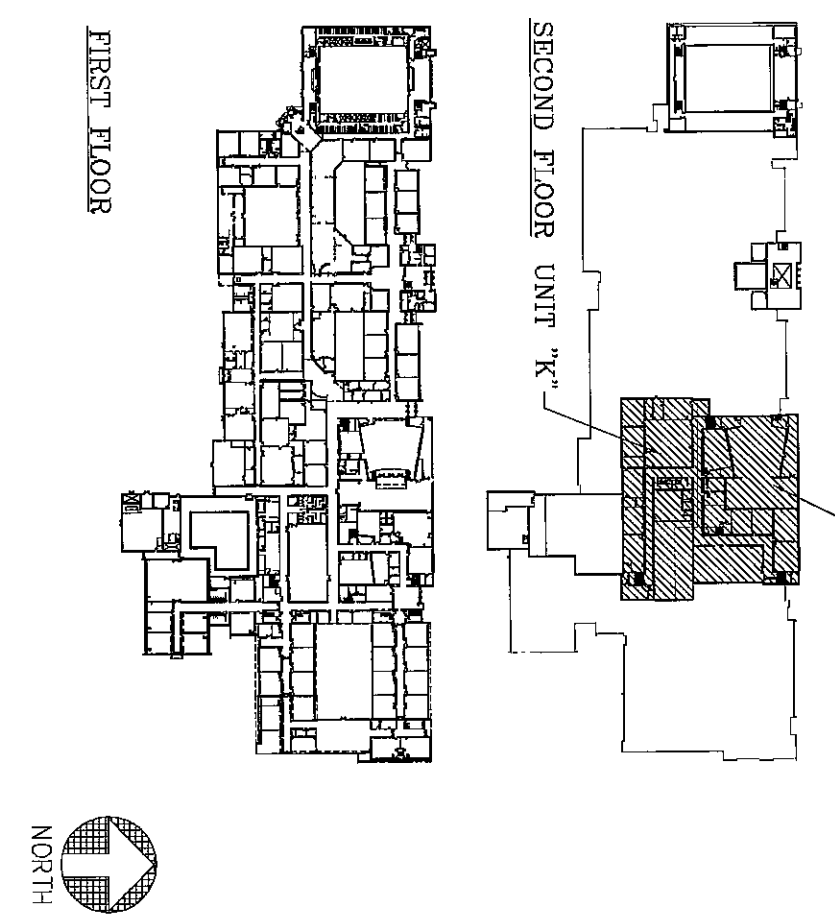

- SYMBOLS/LEGEND**
- UNIT # - CAMERA IDENTIFICATION NUMBER**
- GENERAL NOTES**
1. ROUTE COAX CABLES (PENUM RC-6 TYPE) TO EQUIPMENT ROOM (ER). TERMINATE BOTH ENDS AND TEST.
 2. ROUTE POWER CABLE (PENUM, SIZE PER MFG. REQUIREMENTS) TO EQUIPMENT ROOM (ER) OR TELECOMMUNICATION ROOM (TR) AS SHOWN IN DRAWING 4.1 (1). OUTDOOR CAMERAS TO HAVE A SEPARATE CONDUIT FOR THE FEEDER.
 3. ROUTE DATA CABLE (RS-485) FOR OUTDOOR PAIR/ZOOM CAMERAS PER MFG. REQUIREMENTS TO EQUIPMENT ROOM (ER) AS SHOWN IN DRAWING 4.1 (1).
 4. ROUTE COAX AND POWER CABLES IN EXISTING TELECOMMUNICATION TRAYS WHERE POSSIBLE.
 5. REFERENCED NOTES BELOW ARE NOT NECESSARILY USED ON EVERY DRAWING.
- REFERENCED NOTES**
1. EXISTING TRAY SYSTEM
 2. INDOOR CAMERA, WV-CW174AF MOUNTED IN DROP CEILING. SEE DRAWING 5.1 (4).
 3. INDOOR CAMERA, WV-224CF, MOUNTED IN BRCP CEILING. SEE DRAWING 5.1 (4).
 4. INDOOR CAMERA, WV-CW174AS MOUNTED ON WALL. SEE DRAWING 5.1 (3).
 5. INDOOR CAMERA, WV-CW224CF MOUNTED ON WALL. SEE DRAWING 5.1 (3).
 6. OUTDOOR FIXED CAMERA, WV-CW574 MOUNTED AS SHOWN ON DRAWING 5.1 (6).
 7. OUTDOOR PAN & TILT/ZOOM CAMERA, WV-CW-864A MOUNTED AS SHOWN ON DRAWING 5.1 (2).

2005-18-02

T1.2

DSA, Inc.
Technology Design Consultants
16618 East 196 th Street
Noblesville IN 46060-9530
(765) 534-5152

PROJECT: 04-1033
DRAWN BY: RJJ
CHECKED BY: LMD
SCALE: 1/32"=1'-0"
DATE: 04.28.2005

DUNELAND SCHOOL CORPORATION
CHESTERTON MIDDLE SCHOOL
CHESTERTON, INDIANA
CCTV SYSTEM

REVISIONS/DATE
1. 11/16/05 AS-BUILDS