

- 5 SEE SHF EL.9 FOR CONTINUATION

## NOTES

<b>WIRING SIZING FOR VOLTAGE DROP</b> (200A, 120V, CIRCUITS)	
240'	#10 AWG
375'	#8 AWG
525'	#6 AWG

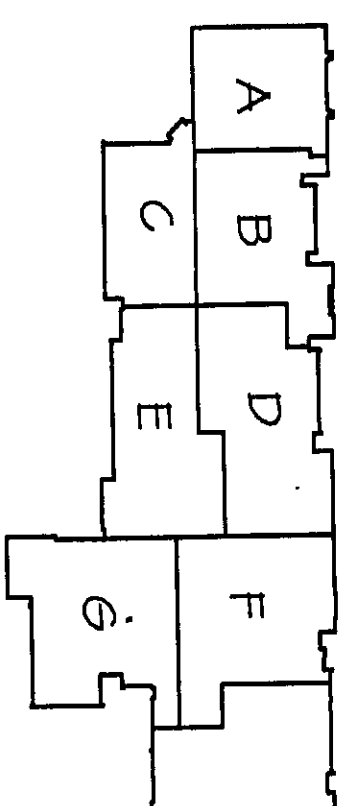
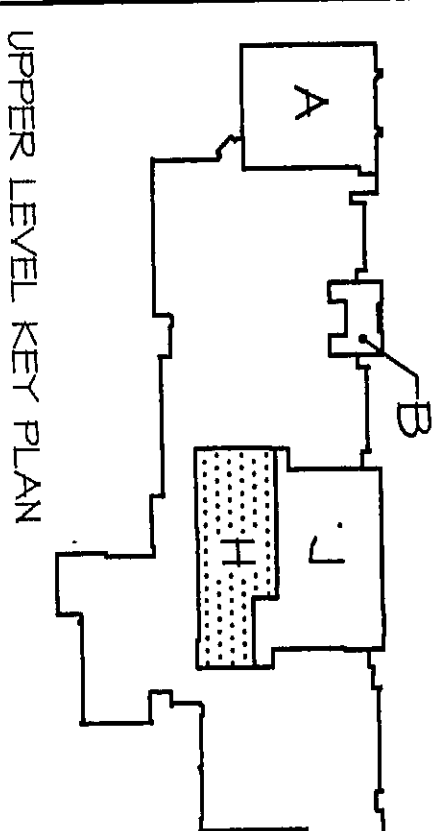

### LOWER LEVEL KEY PLAN

NORTH  
SCALE: 1/8" = 1'-0"

ARCHITECT  
ENGINEER  
PLANNER:

**VEAZEY  
PARROTT  
DURKIN &  
SHOULDERS**

625 Main Street  
Suite 400  
Knoxville, TN 37902

RENOVATION PROJECT FOR:  
DUNELAND SCHOOL CORP.  
CHESTERTON HIGH SCHOOL/MIDDLE SCHOOL  
CHESTERTON, INDIANA

Drawing Title: **LIGHTING PLAN - UNIT H**

Project No:	9980 OC
Project Date:	JUNE 20

Drawn By:	BMH
Approved By:	TLM

E 1.8

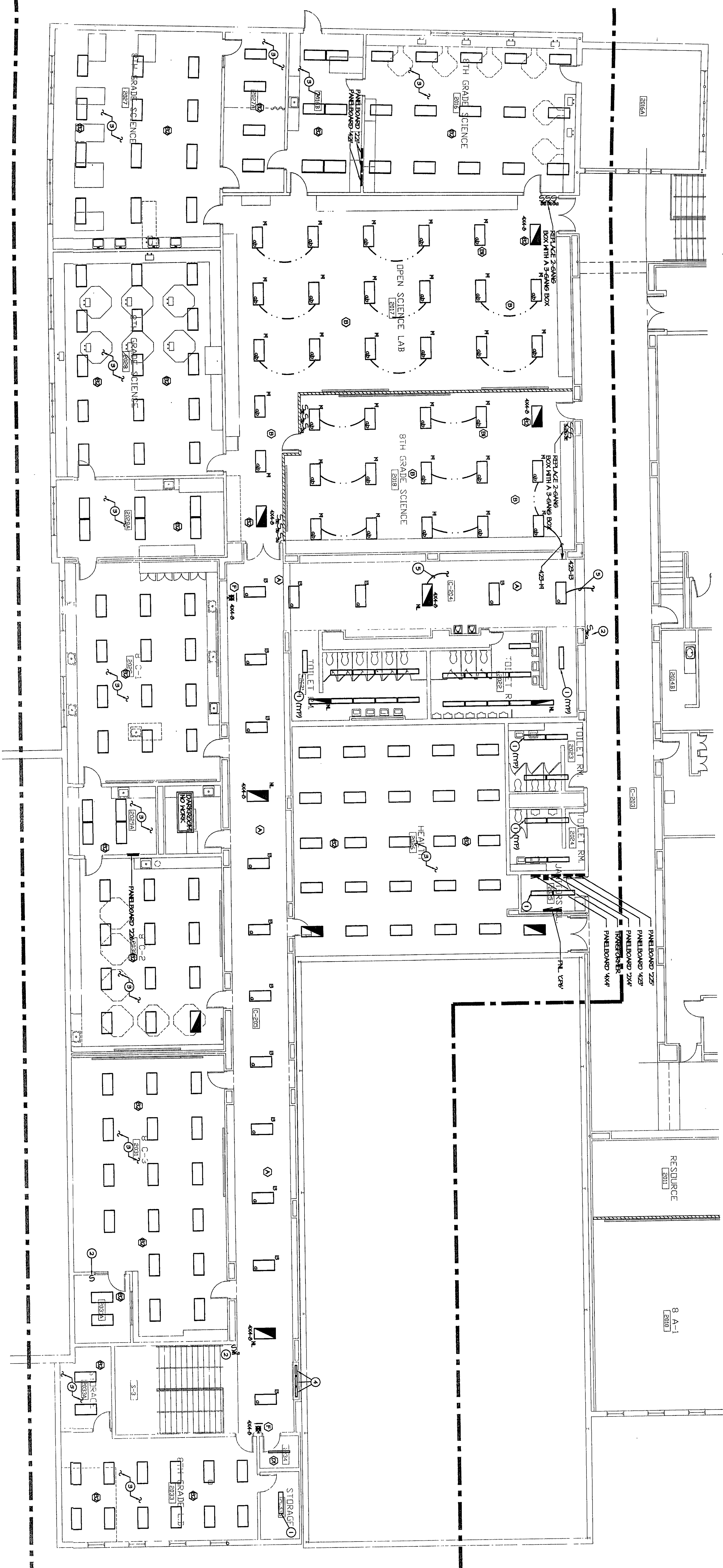

2000-E-22