

1. DISCONNECT AND REMOVE ALL ELECTRICAL WIRING IN THIS AREA, INCLUDING OVERHEAD WIRING.
2. DISCONNECT AND REMOVE ALL LIGHTING FIXTURES, INTERIOR CEILING LIGHTS, SHOCK DETECTORS, HVAC, LESS OVERHEAD WIRING. SHOCK DETECTORS SHALL BE CLEANED AND RE-INSTALLED IN NEW CEILING AT SAME LOCATION.
3. DISCONNECT AND REMOVE LIGHTING FIXTURES, CEILING FANS, AND SWITCHES. LIGHTING SHOULD BE REWired FOR CONNECTION TO NEW LIGHTING FIXTURES AND SWITCHES.
4. SEE SHOP DRAWINGS ON R/F, 501-551, FOR DISCUSSION WORK REQUIRED ON EXISTING PANEL, BOARDS, DISTRIBUTION PANELS AND SWITCHES/BOARDS.
5. ITEMS UNLabeled AS NOT A, OR NOT A-1, SHALL REMAIN. ALL LIGHTING FIXTURES THIS ITEM SHALL BEWired, CONTRACTOR SHALL REMOVE THE LAMP'S, BALLAST, AND DRIVER FOR REPLACEMENT.
6. DISCONNECT AND REMOVE FLOOR WAXED, RESIN, RESIDENTIAL, PATCH FLOOR TO MATCH EXISTING.

GENERAL ELECTRICAL REMOVAL NOTES

- [illegible]

GENERAL ELECTRICAL NOTES:

- A. ALL LIGHTING SWITCHES INDICATED SHALL BE REMOVED FOR REPLACEMENT WITH NEW DEVICES.
- B. INTERCOM SYSTEM - ALL SPEAKERS AND CALL SWITCHES SHALL BE DISCONNECTED AND REMOVED.
- C. CLOCK SYSTEM - ALL CLOCKS SHALL BE DISCONNECTED AND REMOVED.
- D. SEE MECHANICAL REPAIR TENDRY PLANS ON SHEETS NO. 1002 AND 1003 FOR MECHANICAL EQUIPMENT THAT REQUIRES ELECTRICAL DISCONNECTIONS. VERIFY WITH ELECTRICAL POWER PLANS FOR CIRCUITS TO REMAIN FOR RECONNECTION.

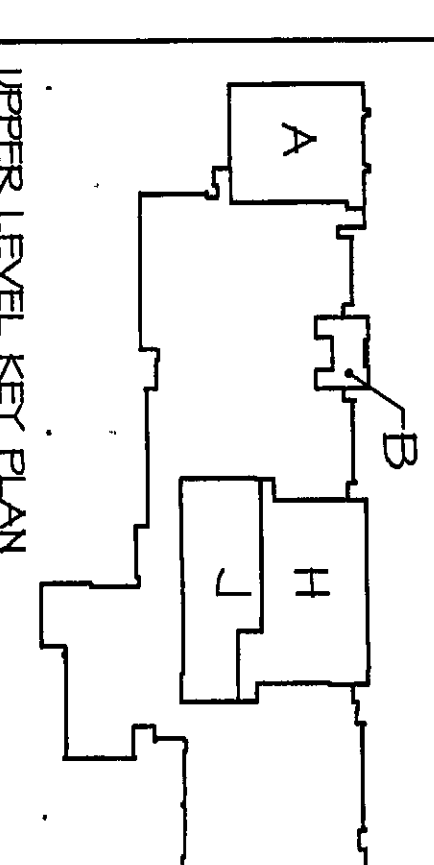

UPPER LEVEL KEY PLAN

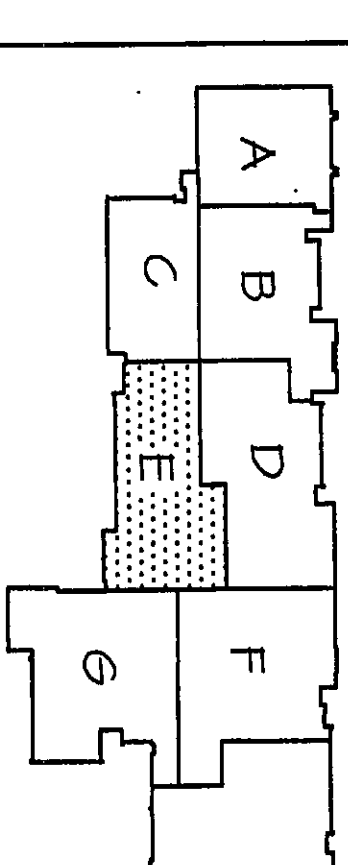

LOWER LEVEL KEY PLAN

NORTH
SCALE: 1/8" = 1'-0"



ARCHITECTS
ENGINEERS
PLANNERS

**VEAZEY
PARROTT
DURKIN &
SHOULDERS**

606 Main Street
Suite 400
Bloomington, In 4706

RENOVATION PROJECT FOR:
DUNELAND SCHOOL CORP.,
CHESTERTON HIGH SCHOOL/MIDDLE SCHOOL,
CHESTERTON, INDIANA

DEMOLITION PLAN - UNIT 5'

Project No:	9480.00
Project Date:	JUNE 2000

Project Date:	JUNE 2000
Drawn By:	BMH

Approved By: TLM
Drawing No:

0.5 E