

TECHNOLOGY PLAN - UNIT J2

SCALE 1/8" = 1'-0"

ROOM LEGEND "J2"			
ROOM NO.	ROOM NAME	AREA S.F.	CEILING HEIGHT
J201	MECHANICAL MEZZANINE	808	9'-4"
J202	MECHANICAL MEZZANINE	234	9'-4"
J203	MECHANICAL MEZZANINE	234	9'-4"
J204	MECHANICAL MEZZANINE	234	9'-4"
J205	MECHANICAL MEZZANINE	234	9'-4"
J206	MECHANICAL MEZZANINE	234	9'-4"
J207	MECHANICAL MEZZANINE	234	9'-4"
J208	MECHANICAL MEZZANINE	234	9'-4"
J209	MECHANICAL MEZZANINE	234	9'-4"
J210	MECHANICAL MEZZANINE	234	9'-4"
J211	MECHANICAL MEZZANINE	234	9'-4"
J212	MECHANICAL MEZZANINE	234	9'-4"
J213	MECHANICAL MEZZANINE	234	9'-4"
J214	MECHANICAL MEZZANINE	234	9'-4"
J215	MECHANICAL MEZZANINE	234	9'-4"
J216	MECHANICAL MEZZANINE	234	9'-4"
J217	MECHANICAL MEZZANINE	234	9'-4"
J218	MECHANICAL MEZZANINE	234	9'-4"
J219	MECHANICAL MEZZANINE	234	9'-4"
J220	MECHANICAL MEZZANINE	234	9'-4"
J221	MECHANICAL MEZZANINE	234	9'-4"
J222	MECHANICAL MEZZANINE	234	9'-4"
J223	MECHANICAL MEZZANINE	234	9'-4"
J224	MECHANICAL MEZZANINE	234	9'-4"
J225	MECHANICAL MEZZANINE	234	9'-4"
J226	MECHANICAL MEZZANINE	234	9'-4"
J227	MECHANICAL MEZZANINE	234	9'-4"
J228	MECHANICAL MEZZANINE	234	9'-4"
J229	MECHANICAL MEZZANINE	234	9'-4"
J230	MECHANICAL MEZZANINE	234	9'-4"
J231	MECHANICAL MEZZANINE	234	9'-4"
J232	MECHANICAL MEZZANINE	234	9'-4"
J233	MECHANICAL MEZZANINE	234	9'-4"
J234	MECHANICAL MEZZANINE	234	9'-4"
J235	MECHANICAL MEZZANINE	234	9'-4"
J236	MECHANICAL MEZZANINE	234	9'-4"
J237	MECHANICAL MEZZANINE	234	9'-4"
J238	MECHANICAL MEZZANINE	234	9'-4"
J239	MECHANICAL MEZZANINE	234	9'-4"
J240	MECHANICAL MEZZANINE	234	9'-4"
J241	MECHANICAL MEZZANINE	234	9'-4"
J242	MECHANICAL MEZZANINE	234	9'-4"
J243	MECHANICAL MEZZANINE	234	9'-4"
J244	MECHANICAL MEZZANINE	234	9'-4"
J245	MECHANICAL MEZZANINE	234	9'-4"
J246	MECHANICAL MEZZANINE	234	9'-4"
J247	MECHANICAL MEZZANINE	234	9'-4"
J248	MECHANICAL MEZZANINE	234	9'-4"
J249	MECHANICAL MEZZANINE	234	9'-4"
J250	MECHANICAL MEZZANINE	234	9'-4"
J251	MECHANICAL MEZZANINE	234	9'-4"
J252	MECHANICAL MEZZANINE	234	9'-4"
J253	MECHANICAL MEZZANINE	234	9'-4"
J254	MECHANICAL MEZZANINE	234	9'-4"
J255	MECHANICAL MEZZANINE	234	9'-4"
J256	MECHANICAL MEZZANINE	234	9'-4"
J257	MECHANICAL MEZZANINE	234	9'-4"
J258	MECHANICAL MEZZANINE	234	9'-4"
J259	MECHANICAL MEZZANINE	234	9'-4"
J260	MECHANICAL MEZZANINE	234	9'-4"
J261	MECHANICAL MEZZANINE	234	9'-4"
J262	MECHANICAL MEZZANINE	234	9'-4"
J263	MECHANICAL MEZZANINE	234	9'-4"
J264	MECHANICAL MEZZANINE	234	9'-4"
J265	MECHANICAL MEZZANINE	234	9'-4"
J266	MECHANICAL MEZZANINE	234	9'-4"
J267	MECHANICAL MEZZANINE	234	9'-4"
J268	MECHANICAL MEZZANINE	234	9'-4"
J269	MECHANICAL MEZZANINE	234	9'-4"
J270	MECHANICAL MEZZANINE	234	9'-4"
J271	MECHANICAL MEZZANINE	234	9'-4"
J272	MECHANICAL MEZZANINE	234	9'-4"
J273	MECHANICAL MEZZANINE	234	9'-4"
J274	MECHANICAL MEZZANINE	234	9'-4"
J275	MECHANICAL MEZZANINE	234	9'-4"
J276	MECHANICAL MEZZANINE	234	9'-4"
J277	MECHANICAL MEZZANINE	234	9'-4"
J278	MECHANICAL MEZZANINE	234	9'-4"
J279	MECHANICAL MEZZANINE	234	9'-4"
J280	MECHANICAL MEZZANINE	234	9'-4"
J281	MECHANICAL MEZZANINE	234	9'-4"
J282	MECHANICAL MEZZANINE	234	9'-4"
J283	MECHANICAL MEZZANINE	234	9'-4"
J284	MECHANICAL MEZZANINE	234	9'-4"
J285	MECHANICAL MEZZANINE	234	9'-4"
J286	MECHANICAL MEZZANINE	234	9'-4"
J287	MECHANICAL MEZZANINE	234	9'-4"
J288	MECHANICAL MEZZANINE	234	9'-4"
J289	MECHANICAL MEZZANINE	234	9'-4"
J290	MECHANICAL MEZZANINE	234	9'-4"
J291	MECHANICAL MEZZANINE	234	9'-4"
J292	MECHANICAL MEZZANINE	234	9'-4"
J293	MECHANICAL MEZZANINE	234	9'-4"
J294	MECHANICAL MEZZANINE	234	9'-4"
J295	MECHANICAL MEZZANINE	234	9'-4"
J296	MECHANICAL MEZZANINE	234	9'-4"
J297	MECHANICAL MEZZANINE	234	9'-4"
J298	MECHANICAL MEZZANINE	234	9'-4"
J299	MECHANICAL MEZZANINE	234	9'-4"
J300	MECHANICAL MEZZANINE	234	9'-4"

GENERAL PLAN NOTES:

1. ALL ROOMS SHALL BE PROVIDED WITH A MINIMUM OF 100 SQUARE FEET OF FLOOR AREA.
2. ALL ROOMS SHALL BE PROVIDED WITH A MINIMUM OF 100 SQUARE FEET OF FLOOR AREA.
3. ALL ROOMS SHALL BE PROVIDED WITH A MINIMUM OF 100 SQUARE FEET OF FLOOR AREA.
4. ALL ROOMS SHALL BE PROVIDED WITH A MINIMUM OF 100 SQUARE FEET OF FLOOR AREA.
5. ALL ROOMS SHALL BE PROVIDED WITH A MINIMUM OF 100 SQUARE FEET OF FLOOR AREA.
6. ALL ROOMS SHALL BE PROVIDED WITH A MINIMUM OF 100 SQUARE FEET OF FLOOR AREA.
7. ALL ROOMS SHALL BE PROVIDED WITH A MINIMUM OF 100 SQUARE FEET OF FLOOR AREA.
8. ALL ROOMS SHALL BE PROVIDED WITH A MINIMUM OF 100 SQUARE FEET OF FLOOR AREA.
9. ALL ROOMS SHALL BE PROVIDED WITH A MINIMUM OF 100 SQUARE FEET OF FLOOR AREA.
10. ALL ROOMS SHALL BE PROVIDED WITH A MINIMUM OF 100 SQUARE FEET OF FLOOR AREA.

PLAN NOTES:

1. SEE DETAIL T5 ON SHEET T5.1 FOR INFORMATION ON CHANGING BETWEEN T5.1 (A) LOCATION & T5.1 (B) OR T5.1 (C) LOCATION.
2. PROVIDE T5.1 DESK SWEL AT EACH CABLE. SECURE PER MANUFACTURER'S RECOMMENDATIONS.
3. LOCATION OF (A) -VIDEO DISTRIBUTION EQUIPMENT, (B) -TELEPHONE SYSTEM, (C) -DATA RACKS & (D) -SOUND SYSTEM (W/F).
4. PROVIDE SINGLE GANG RECESSED BOX FOR DATA RACKS.
5. EXISTING 1/2" CABLE TRAY AS SHOWN.
6. PROVIDE NEW 2" CABLE TRAY TO CORRIDOR.
7. EXISTING 6000 WINDUP. PROVIDE COVER PLATES AS REQUIRED.
8. PROVIDE NEW 2" CABLE TRAY TO CORRIDOR.
9. EXISTING 6000 WINDUP. PROVIDE COVER PLATES AS REQUIRED.
10. PROVIDE NEW 2" CABLE TRAY TO CORRIDOR.

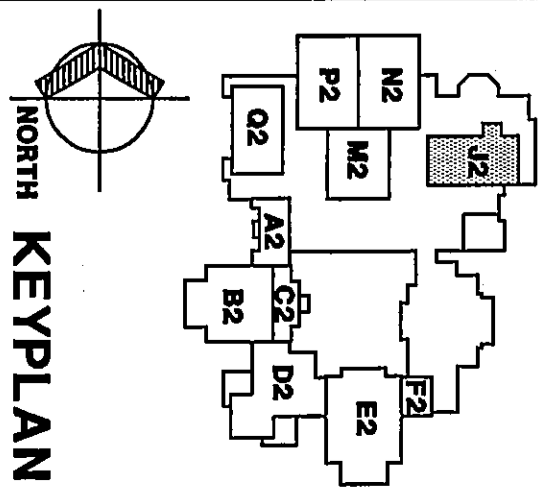

NORTH KEYPLAN

THE NEW
CHESTERTON HIGH SCHOOL
TECHNOLOGY PACKAGE
DUNELAND SCHOOL CORPORATION
CHESTERTON, INDIANA

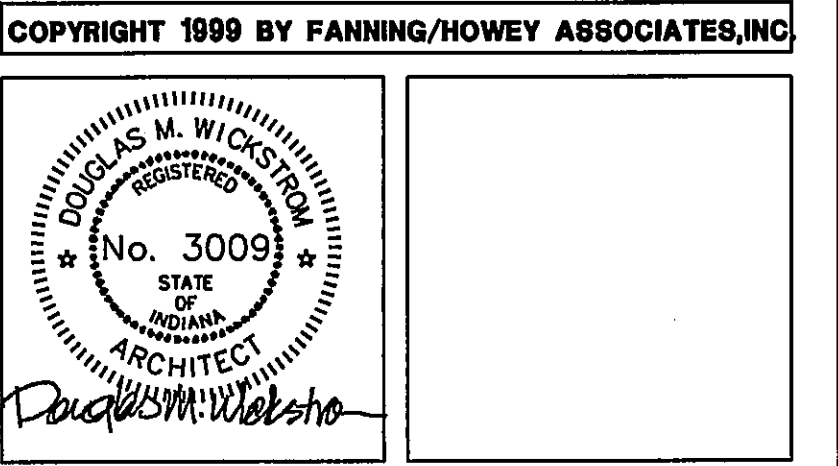

Fanning/Howey
Associates, Inc.
Architects Engineers Consultants

TECHNOLOGYPLAN UNIT J2

DRAWN BY: JED COMM. NO.: 95067.00
CHECKED BY: RSB DATE: MAY 3, 1999

REVISIONS NO. DATE

TE3.15

CHESTERTON HIGH SCHOOL
95067.00

9-17-20