

- KEYNOTES**
- 1 INDICATES FINISH GRADE - REFER TO SITE DRAWINGS
 - 2 CONCRETE STOMP - REFER TO STRUCTURAL DRAWINGS
 - 3 INDICATES FACE BRICK: COLOR 'A' - REFER TO SECTION 04200.
 - 4 INDICATES FACE BRICK: COLOR 'B' - REFER TO SECTION 04200.
 - 5 CAST STONE LEHR @ 99'-4"
 - 6 CAST STONE STARTER COURSE - REFER TO SECTION 04720.
 - 7 CAST STONE WATER TABLE - REFER TO SECTION 04720.
 - 8 CAST STONE SILL - REFER TO SECTION 04720.
 - 9 CAST STONE - REFER TO SECTION 04720.
 - 10 CAST STONE MEDALLION - REFER TO SECTION 04720. (REFER TO DETAIL 6-A5.2 FOR PROFILES)
 - 11 CAST STONE COPING - REFER TO SECTION 04720.
 - 12 CAST STONE PIER CAP - REFER TO SECTION 04720.
 - 13 CAST STONE LINTEL - REFER TO SECTION 04720.
 - 14 PREFORMED METAL FLASHING - REFER TO SECTION 07412.
 - 15 METAL FASCA AND GRAVEL STOP - REFER TO SECTION 07620.
 - 16 METAL GUTTER - REFER TO SECTION 07412.
 - 17 METAL DOWNSPOUT - REFER TO SECTION 07412.
 - 18 METAL COPING - REFER TO SECTION 07600.
 - 19 EPS - REFER TO SECTION 07240.
 - 20 FULLY ADHERED FLEXIBLE SHEET ROOFING - REFER TO SECTION 07531.
 - 21 PREFINISHED METAL FLASHING - REFER TO SECTION 07412.
 - 22 PREFINISHED METAL GRAVEL STOP - REFER TO SECTION 07600.
 - 23 EDUCATIONAL CASEWORK - REFER TO EQUIPMENT PLANS.
 - 24 GMB BULKHEAD PAINTED - REFER TO REFLECTED CEILING PLANS.
 - 25 SLOPED PROJECTION SURFACE AND ACT CEILING ALTERNATE BID.
 - 26 ACT CEILING - REFER TO ROOM FINISH SCHEDULE.
 - 27 DOWNSPOUT BOOT - REFER TO SU SERIES DRAWINGS
 - 28 SPLASH BLOCK

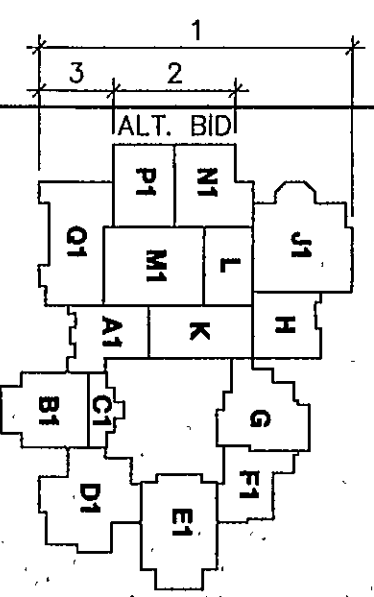

THE NEW
CHESTERTON HIGH SCHOOL
FOR THE
DUNELAND SCHOOL CORPORATION
CHESTERTON, INDIANA

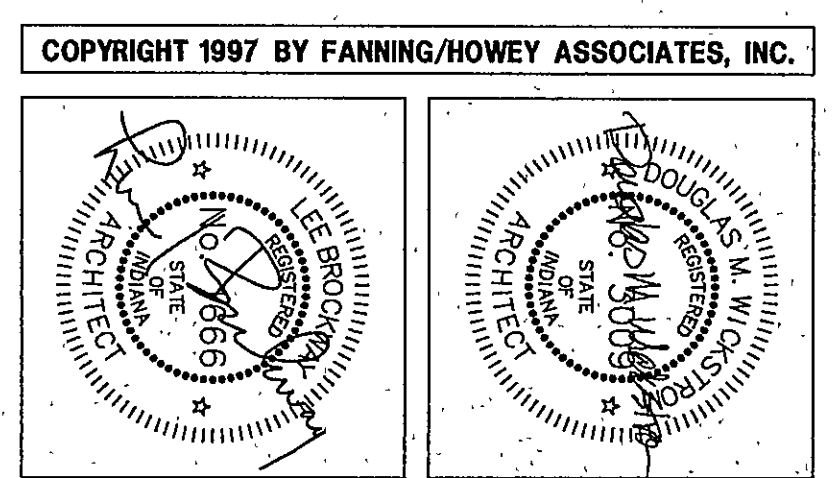

Fanning/Howey Associates, Inc.
Architects Engineers Consultants

BUILDINGS ELEVATION

DRAWN BY: JHJ COMM. NO.: 95067.00
CHECKED BY: JHJ DATE: APRIL 21, 1997

A3.7

REVISIONS NO. DATE

07-A-50