

- 1 INDICATE FINISH GRADE - REFER TO SITE DRAWINGS
- 2 CONCRETE STUOP - REFER TO STRUCTURAL DRAWINGS
- 3 INDICATE FACE BRICK COLOR 'A' - REFER TO SECTION 042000
- 4 INDICATE FACE BRICK COLOR 'B' - REFER TO SECTION 042000
- 5 CAST STONE EDGE @ 98'-4"
- 6 CAST STONE STARTER COURSE - REFER TO SECTION 042120
- 7 CAST STONE WATER TABLE - REFER TO SECTION 042120
- 8 CAST STONE SILL - REFER TO SECTION 042120
- 9 CAST STONE - REFER TO SECTION 042120
- 10 CAST STONE METALLIC - REFER TO SECTION 042120 (REFER TO DETAIL 6-A-5.2 FOR PROFILES)
- 11 CAST STONE COPING - REFER TO SECTION 042120
- 12 CAST STONE PER CAP - REFER TO SECTION 042120
- 13 CAST STONE LUTEL - REFER TO SECTION 042120
- 14 PREFORMED METAL ROOFING - REFER TO SECTION 071412
- 15 METAL FASDA AND GRAVEL STOP - REFER TO SECTION 070800
- 16 METAL GUTTER - REFER TO SECTION 071412
- 17 METAL DOWNSPOUT - REFER TO SECTION 071412
- 18 METAL COPING - REFER TO SECTION 070800
- 19 EIRS - REFER TO SECTION 072401
- 20 TILLY ADHERED FLEXIBLE SLAT ROOFING - REFER TO SECTION 071412
- 21 PREHENSIBLE METAL FLASHING - REFER TO SECTION 071412
- 22 PREHENSIBLE METAL GRAVEL STOP - REFER TO SECTION 070800
- 23 EDUCATIONAL CASKMOR - REFER TO EQUIPMENT PLANS
- 24 ONE BULKHEAD PAINTED - REFER TO REFLECTED CEILING PLAN
- 25 SLOPE PROTECTION SURFACE AND ACT CEILING ALTERNATE BUR
- 26 ACT CEILING - REFER TO ROOM FINISH SCHEDULE
- 27 DOWNSPOUT ROOT - REFER TO SITE SERIES DRAWINGS
- 28 SPANISH BLOCK

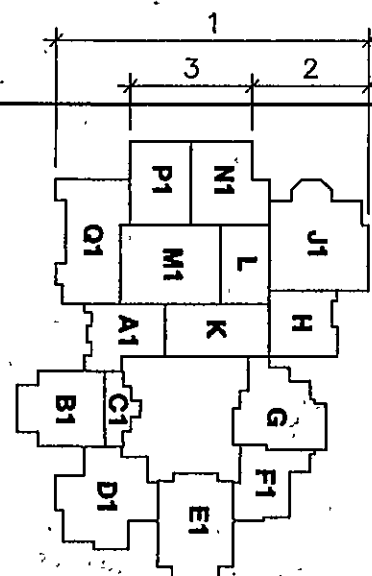

DRAWN BY: JHJ	COMM. NO.: 95067.00
CHECKED BY: JHJ	DATE: APRIL 21, 1997

A3.6

[illegible]

Fanning/Howey
Associates, Inc.

THE NEW
CHESTERTON HIGH SCHOOL
FOR THE
DUNELAND SCHOOL CORPORATION
CHESTERTON, INDIANA

COPYRIGHT 1997, BY FANNING/HOWEY ASSOCIATES, INC.

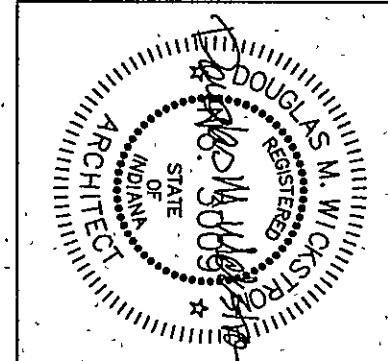
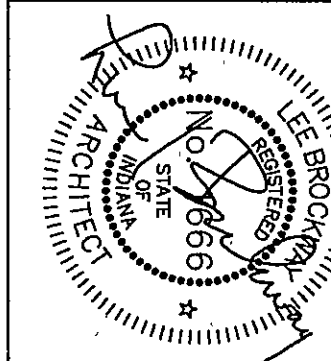
CHESTERTON HIGH SCHOOL
95067 00