

ROOM LEGEND "K1"			
ROOM NO.	ROOM NAME	AREA S.F.	CEILING HEIGHT
K101	NOT USED		
K102	STUDENT DINING	13496	VARIABLES
K103	RESOURCE/CAREER CENTER	3729	9'-4"
K104	RECEPTIONIST	981	9'-4"
K105	CONFERENCE	233	9'-4"
K106	SECRETARY	281	9'-4"
K107	WORKROOM	299	9'-4"
K108	STORAGE	289	9'-4"
K109	CENTRAL STORAGE	446	9'-4"
K110	CORRIDOR OFFICE	155	9'-4"
K111	GUIDANCE OFFICE	199	9'-4"
K112	GUIDANCE OFFICE	204	9'-4"
K113	GUIDANCE OFFICE		
K114	GUIDANCE OFFICE		
K115	GUIDANCE OFFICE		
K116	GUIDANCE OFFICE		
K117	GUIDANCE OFFICE		

#### KEY NOTES

- INDICATES BUILDING LINE ABOVE REFERRED TO IN SECTION 5-A7.29.
- LOCKER BASE - SEE SECTION 5-A7.29.
- INDICATES ROOF OVERHANG - SEE SECTIONS AND DETAILS.
- TYPE I OPERABLE WALL - REFER TO SPEC. SECTION 0920.0 FOR DETAILS.
- TYPE II OPERABLE WALL - REFER TO SPEC. SECTION 0920.0 FOR DETAILS.
- APPLY PLASTER SNA COAT OVER CONC. MASONRY UNITS WHERE INDICATED PER SPEC. SEC. 0920.0.
- METAL STUDS @ 1'-4" O.C. WITH 1/2" GYPSUM BOARD BOTH SIDES - REFER TO SPEC. SEC. 0920.0 FOR DETAILS.
- INDICATES CORNER GUARD - REFER TO SPEC. SEC. 0920.0 FOR DETAILS.
- INDICATES ADA COMPLIANT SHOWER CURB. REFER TO SECTIONS AND DETAILS 12-A7.28.
- DISPLAY CASE - REFER TO EQUIPMENT DRAWINGS.
- LOCKER BENCH/BASE - REFER TO DETAIL 1-A7.30 AND 2-A7.30.
- INDICATES FLOOR TRENCH PER DETAIL 11-S4.5 AND 12-A7.30.
- INDICATES POSTER CASE - REFER TO EQUIPMENT DRAWINGS.
- METAL STUDS @ 1'-4" O.C. W/ 5/8" GYPSUM BOARD ON EXPOSED FACE ONLY - REFER TO SPEC. SECTION 0920.0. SEE NOTE 7 ABOVE REGARDING NOMINAL DIMENSIONS.
- METAL STUDS @ 1'-4" O.C. W/ 5/8" GYPSUM BOARD ON EXPOSED FACE ONLY - REFER TO SPEC. SECTION 0920.0. SEE NOTE 7 ABOVE REGARDING NOMINAL DIMENSIONS.
- INDICATES BUILDING EXPANSION JOINT. REFER TO INDICATED SECTIONS.
- WIRE MESH PARTITIONS-REFER TO SPEC. SEC. 10605.
- INDICATES LADDER-REFER TO SPEC. SEC. 09300.
- LOCKER BASE - SEE SECTION 3-A7.30.

#### FLOOR PLAN NOTES

- WHERE DIFFERENT FLOOR MATERIALS MEET THEY SHALL MEET UNDER THE CENTERLINE OF THE DOOR, UNLESS NOTED OTHERWISE.
- WALLS THAT DO NOT LAY OUT IN FULL OR HALF BLOCK LENGTHS SHOULD BE BRACKETED SO AS NOT TO NOT TO HAVE FEEDS LESS THAN 4" EXPOSED.
- INTERIOR MASONRY WALLS THAT RUN UP TO THE CEILING SHALL BE CONSTRUCTED WITH A 1" RADIUS AT THE CORNER. FINISH FLOOR ELEVATION = 100'-0" FOR THE FIRST FLOOR AND 114'-8" FOR THE SECOND FLOOR.
- WALLS PER SPEC. SEC. 07270 AND BATT INSULATION AT NON-RAISED WALLS THAT ALLOW FOR DETECTION.
- SEE DETAILS ON SHEET A1.3 FOR TYPICAL MASONRY CONTROL JOINTS AND EXPANSION JOINTS.
- SINGLE WYTHE MASONRY WALLS ARE INDICATED AT NOMINAL DIMENSIONS.
- EXPOSED CONCRETE MASONRY UNITS (CMU) CORNERS ARE TO BE CONSTRUCTED USING UNITS WITH A 1" RADIUS AT THE CORNER. FINISH FLOOR ELEVATION = 100'-0" FOR THE FIRST FLOOR AND 114'-8" FOR THE SECOND FLOOR.
- UNLESS OTHERWISE NOTED, THE WALL LENGTH FROM THE OUTER FACE OF DOOR/LITE ROUGH OPENING FINISH WALL IS TO BE FOUR INCHES (4").
- ALL DIMENSIONS UNLESS OTHERWISE NOTED, REFER TO INDICATED PLAN DETAILS OR SECTIONS FOR ACTUAL DIMENSIONS, WHERE INDICATED.
- UNLESS OTHERWISE NOTED, THE WALL LENGTH FROM THE OUTER FACE OF DOOR/LITE ROUGH OPENING FINISH WALL IS TO BE FOUR INCHES (4").
- REFER TO SHEET A1.3 FOR WALL TYPES.
- GENERAL NOTE: BUILDING DIMENSIONS ARE TO FACE OF BRICK.
- GENERAL NOTE: FINISH FLOOR ELEVATION = 100'-0" FOR THE FIRST FLOOR AND 114'-8" FOR THE SECOND FLOOR UNLESS OTHERWISE NOTED.

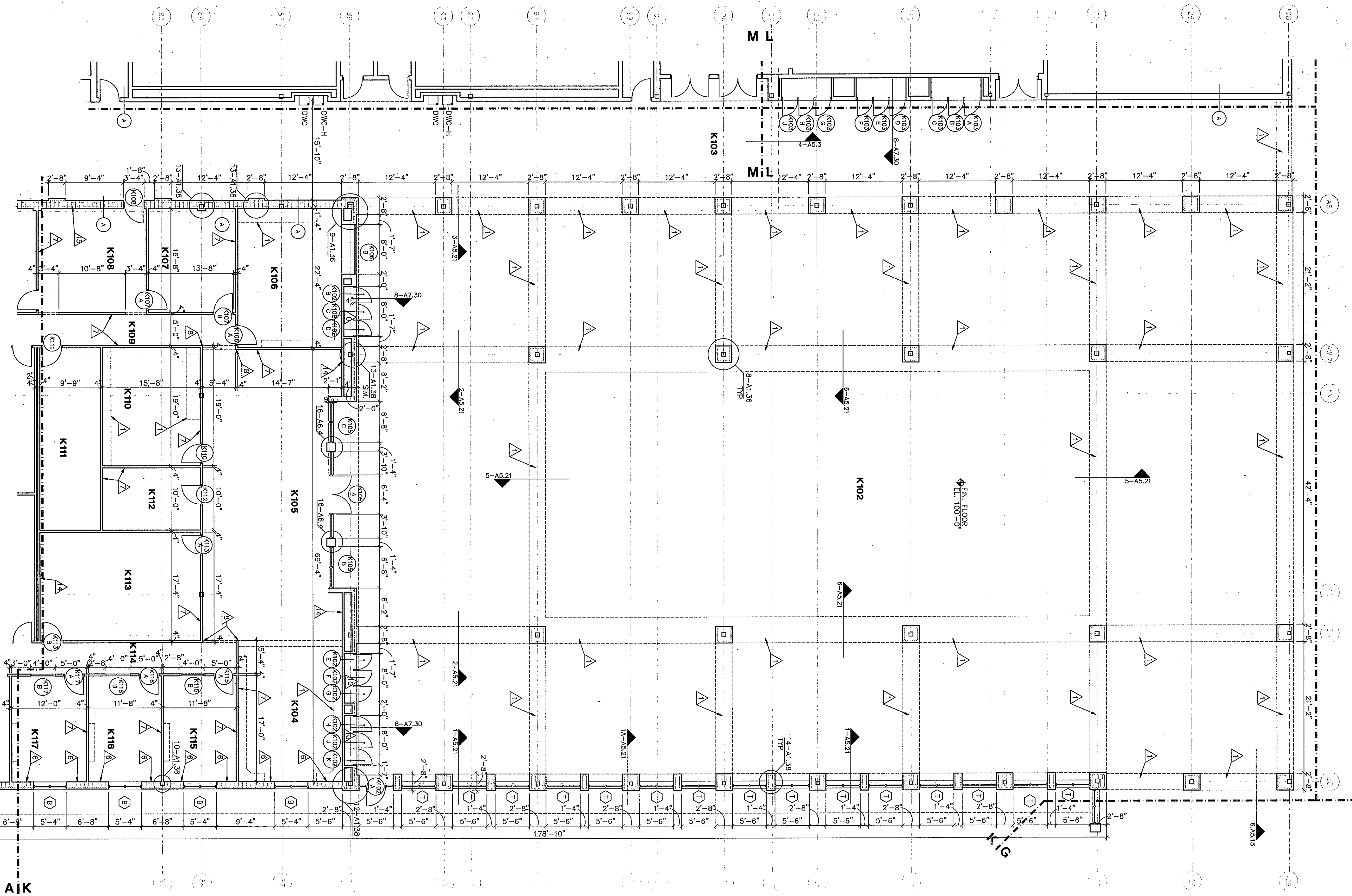

FLOOR PLAN UNIT K

1/8" = 1'-0"

07-A-20

CHESTERTON HIGH SCHOOL  
95067.00

#### FLOOR PLAN UNIT "K1"

DRAWN BY: LEC/LJ COMM. NO.: 95067.00  
CHECKED BY: JHJ DATE: APRIL 21, 1997

A1.18

REVISIONS NO. DATE

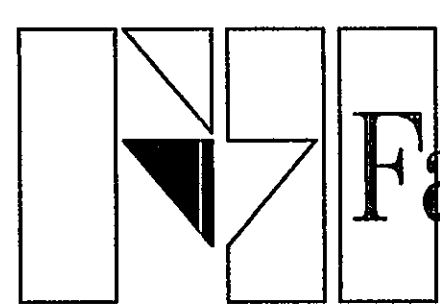

**Fanning/Howey**  
**Associates, Inc.**  
Architects Engineers Consultants

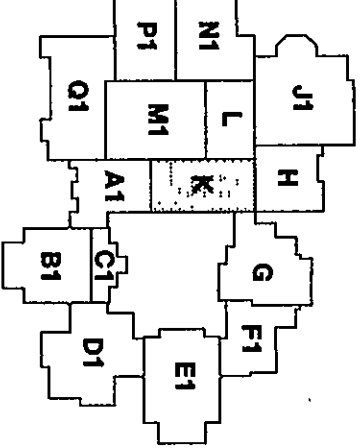

THE NEW  
**CHESTERTON HIGH SCHOOL**  
FOR THE  
DUNELAND SCHOOL CORPORATION  
CHESTERTON, INDIANA

COPYRIGHT 1997 BY FANNING/HOWEY ASSOCIATES, INC.

