

ROOM LEGEND "J2"			
ROOM NO.	NAME	AREA	CEILING HEIGHT
J201	MECHANICAL MEZZANINE	808	9'-4"
J202	MECHANICAL MEZZANINE	808	9'-4"
J203	MECHANICAL MEZZANINE	808	9'-4"
J204	MECHANICAL MEZZANINE	808	9'-4"
J205	MECHANICAL MEZZANINE	808	9'-4"
J206	MECHANICAL MEZZANINE	808	9'-4"
J207	MECHANICAL MEZZANINE	808	9'-4"
J208	MECHANICAL MEZZANINE	808	9'-4"
J209	MECHANICAL MEZZANINE	808	9'-4"
J210	MECHANICAL MEZZANINE	808	9'-4"
J211	MECHANICAL MEZZANINE	808	9'-4"
J212	MECHANICAL MEZZANINE	808	9'-4"
J213	MECHANICAL MEZZANINE	808	9'-4"
J214	MECHANICAL MEZZANINE	808	9'-4"
J215	MECHANICAL MEZZANINE	808	9'-4"
J216	MECHANICAL MEZZANINE	808	9'-4"
J217	MECHANICAL MEZZANINE	808	9'-4"
J218	MECHANICAL MEZZANINE	808	9'-4"
J219	MECHANICAL MEZZANINE	808	9'-4"
J220	MECHANICAL MEZZANINE	808	9'-4"
J221	MECHANICAL MEZZANINE	808	9'-4"
J222	MECHANICAL MEZZANINE	808	9'-4"
J223	MECHANICAL MEZZANINE	808	9'-4"
J224	MECHANICAL MEZZANINE	808	9'-4"
J225	MECHANICAL MEZZANINE	808	9'-4"
J226	MECHANICAL MEZZANINE	808	9'-4"
J227	MECHANICAL MEZZANINE	808	9'-4"
J228	MECHANICAL MEZZANINE	808	9'-4"
J229	MECHANICAL MEZZANINE	808	9'-4"
J230	MECHANICAL MEZZANINE	808	9'-4"
J231	MECHANICAL MEZZANINE	808	9'-4"
J232	MECHANICAL MEZZANINE	808	9'-4"
J233	MECHANICAL MEZZANINE	808	9'-4"
J234	MECHANICAL MEZZANINE	808	9'-4"
J235	MECHANICAL MEZZANINE	808	9'-4"
J236	MECHANICAL MEZZANINE	808	9'-4"
J237	MECHANICAL MEZZANINE	808	9'-4"
J238	MECHANICAL MEZZANINE	808	9'-4"
J239	MECHANICAL MEZZANINE	808	9'-4"
J240	MECHANICAL MEZZANINE	808	9'-4"
J241	MECHANICAL MEZZANINE	808	9'-4"
J242	MECHANICAL MEZZANINE	808	9'-4"
J243	MECHANICAL MEZZANINE	808	9'-4"
J244	MECHANICAL MEZZANINE	808	9'-4"
J245	MECHANICAL MEZZANINE	808	9'-4"
J246	MECHANICAL MEZZANINE	808	9'-4"
J247	MECHANICAL MEZZANINE	808	9'-4"
J248	MECHANICAL MEZZANINE	808	9'-4"
J249	MECHANICAL MEZZANINE	808	9'-4"
J250	MECHANICAL MEZZANINE	808	9'-4"
J251	MECHANICAL MEZZANINE	808	9'-4"
J252	MECHANICAL MEZZANINE	808	9'-4"
J253	MECHANICAL MEZZANINE	808	9'-4"
J254	MECHANICAL MEZZANINE	808	9'-4"
J255	MECHANICAL MEZZANINE	808	9'-4"
J256	MECHANICAL MEZZANINE	808	9'-4"
J257	MECHANICAL MEZZANINE	808	9'-4"
J258	MECHANICAL MEZZANINE	808	9'-4"
J259	MECHANICAL MEZZANINE	808	9'-4"
J260	MECHANICAL MEZZANINE	808	9'-4"
J261	MECHANICAL MEZZANINE	808	9'-4"
J262	MECHANICAL MEZZANINE	808	9'-4"
J263	MECHANICAL MEZZANINE	808	9'-4"
J264	MECHANICAL MEZZANINE	808	9'-4"
J265	MECHANICAL MEZZANINE	808	9'-4"
J266	MECHANICAL MEZZANINE	808	9'-4"
J267	MECHANICAL MEZZANINE	808	9'-4"
J268	MECHANICAL MEZZANINE	808	9'-4"
J269	MECHANICAL MEZZANINE	808	9'-4"
J270	MECHANICAL MEZZANINE	808	9'-4"
J271	MECHANICAL MEZZANINE	808	9'-4"
J272	MECHANICAL MEZZANINE	808	9'-4"
J273	MECHANICAL MEZZANINE	808	9'-4"
J274	MECHANICAL MEZZANINE	808	9'-4"
J275	MECHANICAL MEZZANINE	808	9'-4"
J276	MECHANICAL MEZZANINE	808	9'-4"
J277	MECHANICAL MEZZANINE	808	9'-4"
J278	MECHANICAL MEZZANINE	808	9'-4"
J279	MECHANICAL MEZZANINE	808	9'-4"
J280	MECHANICAL MEZZANINE	808	9'-4"
J281	MECHANICAL MEZZANINE	808	9'-4"
J282	MECHANICAL MEZZANINE	808	9'-4"
J283	MECHANICAL MEZZANINE	808	9'-4"
J284	MECHANICAL MEZZANINE	808	9'-4"
J285	MECHANICAL MEZZANINE	808	9'-4"
J286	MECHANICAL MEZZANINE	808	9'-4"
J287	MECHANICAL MEZZANINE	808	9'-4"
J288	MECHANICAL MEZZANINE	808	9'-4"
J289	MECHANICAL MEZZANINE	808	9'-4"
J290	MECHANICAL MEZZANINE	808	9'-4"
J291	MECHANICAL MEZZANINE	808	9'-4"
J292	MECHANICAL MEZZANINE	808	9'-4"
J293	MECHANICAL MEZZANINE	808	9'-4"
J294	MECHANICAL MEZZANINE	808	9'-4"
J295	MECHANICAL MEZZANINE	808	9'-4"
J296	MECHANICAL MEZZANINE	808	9'-4"
J297	MECHANICAL MEZZANINE	808	9'-4"
J298	MECHANICAL MEZZANINE	808	9'-4"
J299	MECHANICAL MEZZANINE	808	9'-4"
J300	MECHANICAL MEZZANINE	808	9'-4"

KEY NOTES

- INDICATES BUILDING LINE ABOVE — REFER TO INDICATED SECTIONS, DETAILS, REFLECTED CEILING PLANS, AND INTERIOR ELEVATIONS.
- LOCKER BASE — SEE SECTION 5-A729
- INDICATES ROOF DRAINING — SEE SECTIONS AND DETAILS
- TYPE I OPERABLE WALL — REFER TO SPEC. SECTION 10650. REFER TO EQUIP. PLANS FOR LOCATIONS OF WRITING SURFACE.
- TYPE II OPERABLE WALL — REFER TO SPEC. SECTION 10650. REFER TO EQUIP. PLANS FOR LOCATIONS OF WRITING SURFACE.
- APPLY PLASTER SKIN COAT OVER CONC. MASONRY UNITS WHERE INDICATED PER SPEC. SEC. 09200.
- METAL STUDS @ 1'-4" O.C. WITH 1/2" Gypsum Board Bottom Joists — REFER TO ARE NOMINAL AND TO FACE OF STUD. (I.E. 4" x 5/8" METAL STUDS)
- INDICATES CORNER GUARD — REFER TO CORNER PARTITIONS DESCRIBED IN NOTE 7.
- INDICATES ADA COMPLIANT SHOWER CURB. REFER TO SECTIONS AND DETAILS 12-A729.
- DISPLAY CASE — REFER TO EQUIPMENT DRAWINGS.
- LOCKER BENCH/BASE — REFER TO DETAIL 11-A729.
- INDICATES FLOOR FINISH PER DETAIL 11-A729.
- CORPORATE LOCATIONS WITH FLOOR FINISHES AND CASEWORK.
- INDICATES POSTER CASE — REFER TO EQUIPMENT DRAWINGS.
- METAL STUDS @ 1'-4" O.C. W/5/8" GYPSUM BOARD ON EXPOSED FACE ONLY — REFER TO SPEC. SECTION 09200. NOTE 7 ABOVE REGARDING NOMINAL DIMENSIONS.
- METAL STUDS @ 1'-4" O.C. W/5/8" GYPSUM BOARD ON EXPOSED FACE, AND 5/8" GYPSUM SHEATHING TOWARD BRICK FACE. ALSO SEE WALL SECTION 1-A54.
- BUILT-IN BENCH, REFER TO DETAIL 18-A729.
- INDICATES BUILDING EXPANSION JOINT, REFER TO INDICATED SECTIONS.
- WIRE MESH PARTITIONS—REFER TO SPEC. SEC. 10905.
- INDICATES LADDER—REFER TO SPEC. SEC. 09500.
- LOCKER BASE — SEE SECTION 5-A730

FLOOR PLAN NOTES

- WHERE DIFFERENT FLOOR MATERIALS MEET THEY SHALL MEET UNDER THE CENTERLINE OF THE DOOR, UNLESS NOTED OTHERWISE.
- WALLS THAT DO NOT LAY OUT IN FULL OR HALF BLOCK LENGTHS SHOULD BE BALANCED SO AS NOT TO HAVE FIELDS LESS THAN 4' EXPOSED.
- INTERIOR MASONRY WALLS THAT RUN UP TO THE CEILING SHALL BE CONSTRUCTED WITH A 1" RADIUS AT THE DECK FILLED WITH FIRESTOPPING AT RATED AT NON-RATED WALLS THAT ALLOW FOR DEFLECTION. SEE DETAILS ON SHEET A1.31 FOR TYPICAL MASONRY CONTROL JOINTS AND EXPANSION JOINTS.
- SINGLE W/TH MASONRY WALLS ARE INDICATED AT NOMINAL DIMENSIONS.
- EXPOSED CONCRETE MASONRY UNITS (CMU) CORNERS ARE TO BE CONSTRUCTED USING UNITS WITH A 1" RADIUS TO LOCKERS. USE BUILDING CORNER UP TO UNDERBONE OF CEILING OR BULKHEAD PLANE. ABOVE THIS PLANE USE CMU W/O BULKHEAD CORNER.
- FINISH FLOOR ELEVATION INDICATED FOR THE BUILDING IS 100'-0". REFER TO THE SITE PLAN FOR CORRELATION TO USGS DATUM.
- SEE SHEET A726 FOR MOUNTING HEIGHTS.
- INTERIOR AND EXTERIOR CMU WALLS ARE TO BE CONSTRUCTED WITH A 1" RADIUS AT THE CORNERS. SEE DETAILS ON SHEET A1.31 FOR TYPICAL MASONRY CONTROL JOINTS AND EXPANSION JOINTS.
- ALL DIMENSIONS INDICATED ARE NOMINAL. METAL STUD WALLS ARE DIMENSIONED TO FACE OF STUDS. REFER TO INDICATED PLAN DETAILS OR SECTIONS FOR ACTUAL DIMENSIONS, WHERE INDICATED.
- UNLESS OTHERWISE NOTED, THE WALL LENGTH FROM THE FACE OF STUD TO THE FACE OF STUD (THE EXTERIOR INTERFACING WALL IS TO BE FOUR INCHES (4")
- REFER TO SHEET A1.3 FOR WALL TYPES.
- GENERAL NOTE: BUILDING DIMENSIONS ARE TO FACE OF BRICK.
- GENERAL NOTE: FINISH FLOOR ELEVATION = 100'-0" FOR THE FIRST FLOOR AND 114'-8" FOR THE SECOND FLOOR UNLESS OTHERWISE NOTED.

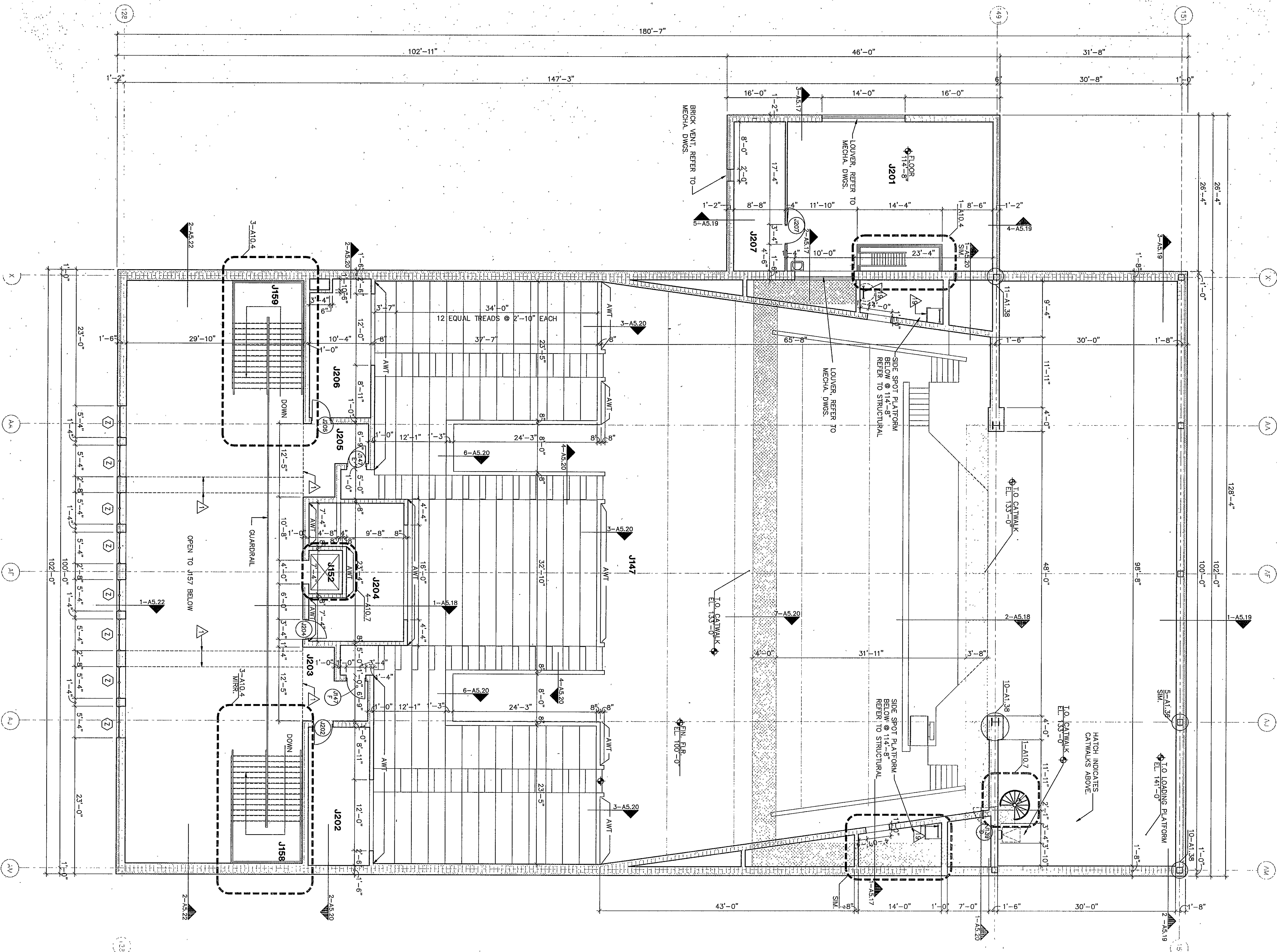

FLOOR PLAN UNIT J2