

ROOM LEGEND "P2"			
ROOM NO.	ROOM NAME	AREA	CEILING
P201	STAIR	681	10'-8"
P202	MECHANICAL ROOM	2725	7'-4"
P203	MECHANICAL ROOM	2725	7'-4"
P204	BALCONY COURT	4226	---

EQUIPMENT PLAN GENERAL NOTES

- INDICATES SCHEDULED RESIDENTIAL AND SPECIALTY CASEWORK. REFER TO SPECIFICATION SECTION 11450 FOR SCHEDULE.
- INDICATES SCHEDULED DARKROOM CASEWORK. REFER TO SPECIFICATION SECTION 11470 FOR SCHEDULE.
- INDICATES SCHEDULED PHYSICAL EDUCATION CASEWORK. REFER TO SPECIFICATION SECTION 11480 FOR SCHEDULE.
- INDICATES SCHEDULED MEDIA CENTER CASEWORK. REFER TO SPECIFICATION SECTION 12315 FOR SCHEDULE.
- INDICATES SCHEDULED EDUCATIONAL CASEWORK. REFER TO SPECIFICATION SECTION 12324 FOR SCHEDULE.
- INDICATES SCHEDULED SCIENCE CASEWORK. REFER TO SPECIFICATION SECTION 12345 FOR SCHEDULE.
- INDICATES SCHEDULED MUSIC CASEWORK. REFER TO SPECIFICATION SECTION 12324 FOR SCHEDULE.
- COUNTERTOPS SHALL BE PROVIDED WITH A 4" HIGH BACKSPASH AND UNDERLASH EXCEPT WHEN DETAILD OTHERWISE.
- PROVIDE RILLERS AS REQUIRED BETWEEN CASEWORK UNITS AND OTHER WALL UNITS AND WALL.
- PROVIDE CONTINUOUS COUNTERTOPS.
- ALL EXPOSED ENDS AND BACKS SHALL BE FINISHED.
- THE CABINET INSTALLER SHALL CAULK BETWEEN COUNTERTOPS AND BACKS/CLASHES, ENDS/CLASHES AND WALLS.
- THE CABINET INSTALLER SHALL CUT CASEWORK UNITS AS REQUIRED FOR PLUMBING/ELECTRICAL LINES AND CABINET-INSTALLED EQUIPMENT.
- ALL WALL-MOUNTED CASEWORK SHALL BE MOUNTED WITH THE TOP @ 7'-0" A.F.F. UNLESS NOTED OTHERWISE.
- SEE SHEET A7.28 FOR MOUNTING HEIGHTS.
- ALL CASEWORK DOORS AND DRAWERS SHALL BE LOCKABLE - KEYS PER ROOM UNLESS NOTED OTHERWISE.
- CABINETS INDICATED TO RECEIVE SINKS SHALL BE CONSTRUCTED TO RECEIVE SINKS IN ACCORDANCE WITH SINK SIZES INDICATED COORDINATE WITH DIVISION 15 FOR SINK SIZES.
- PROVIDE A FINISHED TOP ON ALL CABINETS THAT DO NOT HAVE A BULKHEAD ABOVE THEM.
- PROVIDE ABOVE ALL WALL CABINETS BELOW BULKHEADS CLOSURE PIECE. REFER TO DETAIL 3-A7.28.
- REFER TO DETAIL 4-A7.29 FOR WALL CABINET CONSTRUCTION.
- VERIFY LOCATION OF T.V. MONITOR IN CLASSROOMS IF ALTERNATIVE FOR THE SLOPED PROJECTION SCREEN IS NOT ACCEPTED.

LOCKER LEGEND

- 12" X 12" X 60" STANDARD LOCKERS
REFER TO DETAIL 9-A7.29 & SPEC. SECT. 10500.
 - 12" X 12" X 72" STANDARD LOCKERS WITH SLOPED TOPS - REFER TO DETL 3-A7.30 & SPEC. SECT. 10500
 - 12" X 12" X 60" ATHLETIC LOCKERS WITH SLOPED TOPS - REFER TO DETAILS 1-A7.30 & 2-A7.30 AND SPEC. SECTION 10500
 - 12" X 12" X 12" 5 TIER HIGH ATHLETIC LOCKERS WITH SLOPED TOPS - REFER TO SECTION 10500
 - 24" X 18" X 72" ATHLETIC LOCKERS WITH SLOPED TOPS - REFER TO DETAIL 1-A7.30 & SPEC. SECT. 10500
 - 24" X 24" X 72" ATHLETIC LOCKERS WITH SLOPED TOPS - REFER TO DETAIL 3-A7.30 & SPEC. SECT. 10500
- PROVIDE LOCKERS FOR THE PHYSICALLY CHALLENGED PER SPEC. SECTION 10500.

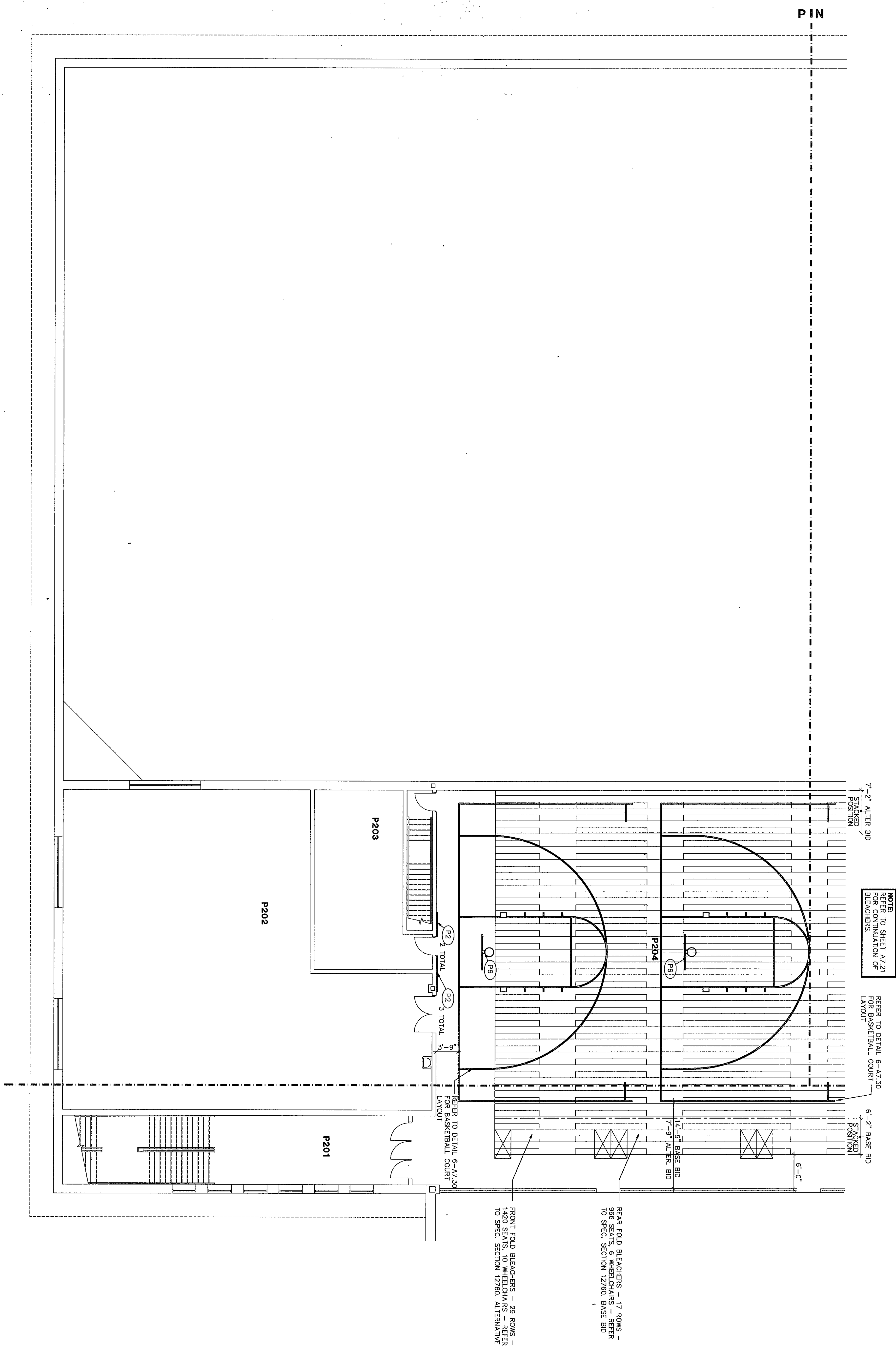

EQUIPMENT PLAN UNIT P2

3/8"=1'-0"

Fanning/Howey Associates, Inc.
Architects Engineers Consultants

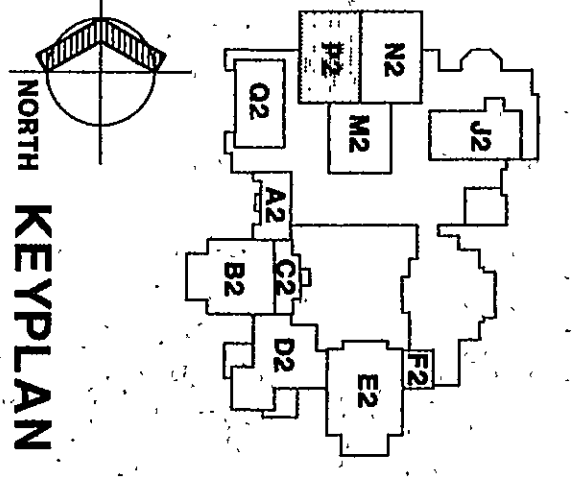

THE NEW
CHESTERTON HIGH SCHOOL
FOR THE
DUNELAND SCHOOL CORPORATION
CHESTERTON, INDIANA

Copyright 1997 by Fanning/Howey Associates, Inc.

EQUIPMENT PLAN UNIT P2

DRAWN BY: LEC/SB COMM. NO.: 95067.00
CHECKED BY: JHJ DATE: APRIL 21, 1997

A7.23

REVISIONS NO. DATE

CHESTERTON HIGH SCHOOL
95067.00