

ROOM LEGEND "P1"

ROOM NO.	ROOM NAME	AREA	CEILING HEIGHT
P101	MEN'S TOILET	425	9'-4"
P102	ATHLETIC STORAGE	234	9'-4"
P103	DRINKING ROOM	49	9'-4"
P104	SHOWER	130	9'-4"
P105	LOCKER	71	9'-4"
P106	TOILET	19	9'-4"
P107	COACH LOCKER	52	9'-4"
P108	TOILET	72	9'-4"
P109	BOYS' PE LOCKER	104	9'-4"
P110	SHOWER ROOM	130	9'-4"
P111	CONCESSION STAND	333	9'-4"
P112	CHANGEROOM	180	10'-0"
P113	ELECTRICAL ROOM	89	10'-0"

EQUIPMENT PLAN GENERAL NOTES

- INDICATES SCHEDULED RESIDENTIAL AND SPECIALTY CASEWORK. REFER TO SPECIFICATION SECTION 11450 FOR SCHEDULE.
- INDICATES SCHEDULED DAYROOM CASEWORK. REFER TO SPECIFICATION SECTION 11470 FOR SCHEDULE.
- INDICATES SCHEDULED PHYSICAL EDUCATION CASEWORK. REFER TO SPECIFICATION SECTION 11480 FOR SCHEDULE.
- INDICATES SCHEDULED MEDIA CENTER CASEWORK. REFER TO SPECIFICATION SECTION 12315 FOR SCHEDULE.
- INDICATES SCHEDULED EDUCATIONAL CASEWORK. REFER TO SPECIFICATION SECTION 12324 FOR SCHEDULE.
- INDICATES SCHEDULED SCIENCE CASEWORK. REFER TO SPECIFICATION SECTION 12345 FOR SCHEDULE.
- INDICATES SCHEDULED MUSIC CASEWORK. REFER TO SPECIFICATION SECTION 12324 FOR SCHEDULE.
- COUNTERTOPS SHALL BE PROVIDED WITH A 4" HIGH BACKSPASH AND ENDSPLASH EXCEPT WHEN DETAILED OTHERWISE. PROVIDE FILLERS AS REQUIRED BETWEEN CASEWORK UNITS AND OTHER WALL UNITS AND WALL.
- PROVIDE CONTINUOUS COUNTERTOPS.
- ALL EXPOSED EDGES AND BACKS SHALL BE FINISHED.
- THE CABINET INSTALLER SHALL CALL OUT BETWEEN COUNTERTOPS AND BACKSPASHES, ENDSPLASHES AND WALLS.
- THE CABINET INSTALLER SHALL CUT CASEWORK UNITS AS REQUIRED FOR PLUMBING/ELECTRICAL LINES AND CABINET-INSTALLED EQUIPMENT.
- ALL WALL-MOUNTED CASEWORK SHALL BE MOUNTED WITH THE TOP @ 7'-0" A.F.F. UNLESS NOTED OTHERWISE.
- SEE SHEET A7.26 FOR MOUNTING HEIGHTS.
- ALL CASEWORK DOORS AND DRAWERS SHALL BE LOCKABLE - KEYS PER ROOM UNLESS NOTED OTHERWISE.
- CABINETS INDICATED TO RECEIVE SINKS SHALL BE CONSTRUCTED TO ALLOW FOR INSTALLATION OF SINKS FOR SIZES INDICATED. COORDINATE WITH DIVISION 15 FOR SINK SIZES.
- PROVIDE A FINISHED TOP ON ALL CABINETS THAT DO NOT HAVE A BULKHEAD ABOVE THEM.
- PROVIDE ABOVE ALL WALL CABINETS BELOW BULKHEADS CLOSURE PIECE. REFER TO DETAIL 3-A7.29.
- REFER TO DETAIL 4-A7.29 FOR WALL CABINET CONSTRUCTION.
- VARYING LOCATION OF TV MONITOR IN CLASSROOMS IF ALTERNATIVE FOR THE SLOPED PROJECTION SCREEN IS NOT ACCEPTED.

LOCKER LEGEND

- 12" X 12" X 60" STANDARD LOCKERS  
REFER TO DETAIL 3-A7.28 & SPEC. SECT. 10500.
- 12" X 12" X 72" STANDARD LOCKERS  
WITH SLOPED TOPS - REFER TO DETAIL 3-A7.30 & SPEC. SECT. 10500.
- 12" X 12" X 60" ATHLETIC LOCKERS  
WITH SLOPED TOPS - REFER TO DETAIL 3-A7.30 & SPEC. SECT. 10500.
- 12" X 12" X 72" TIER HIGH ATHLETIC LOCKERS WITH SLOPED TOPS - REFER TO DETAIL 3-A7.30 AND SPEC. SECT. 10505.
- 24" X 18" X 72" ATHLETIC LOCKERS WITH SLOPED TOPS - REFER TO DETAIL 3-A7.30 & SPEC. SECT. 10505.
- PROVIDE LOCKERS FOR THE PHYSICALLY CHALLENGED PER SPEC. SECTION 10500.

ROOM LEGEND "P1"

ROOM NO.	ROOM NAME	AREA	CEILING HEIGHT
P101	MEN'S TOILET	425	9'-4"
P102	ATHLETIC STORAGE	234	9'-4"
P103	DRINKING ROOM	49	9'-4"
P104	SHOWER	130	9'-4"
P105	LOCKER	71	9'-4"
P106	TOILET	19	9'-4"
P107	COACH LOCKER	52	9'-4"
P108	TOILET	72	9'-4"
P109	BOYS' PE LOCKER	104	9'-4"
P110	SHOWER ROOM	130	9'-4"
P111	CONCESSION STAND	333	9'-4"
P112	CHANGEROOM	180	10'-0"
P113	ELECTRICAL ROOM	89	10'-0"

THE NEW

CHESTERTON HIGH SCHOOL

FOR THE

DUNELAND SCHOOL CORPORATION

CHESTERTON, INDIANA

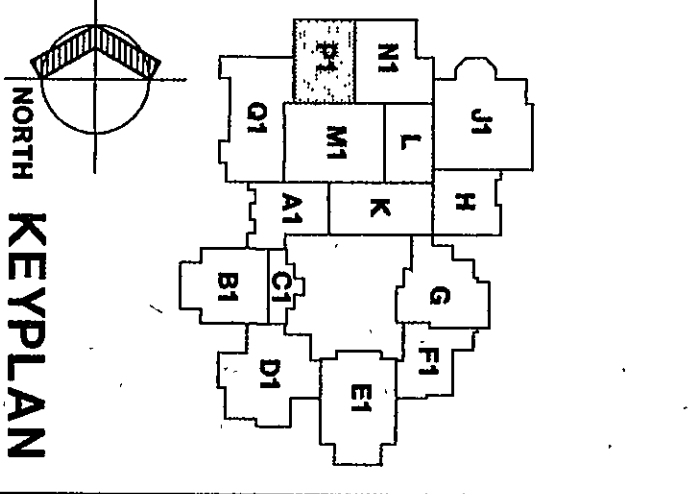

Fanning/Howey

Associates, Inc.

Architects Engineers Consultants

EQUIPMENT PLAN UNIT P1

DRAWN BY: LEC/SB    COMM. NO.: 95067.00  
CHECKED BY: JHJ    DATE: APRIL 21, 1997

A7.22

REVISIONS NO. DATE

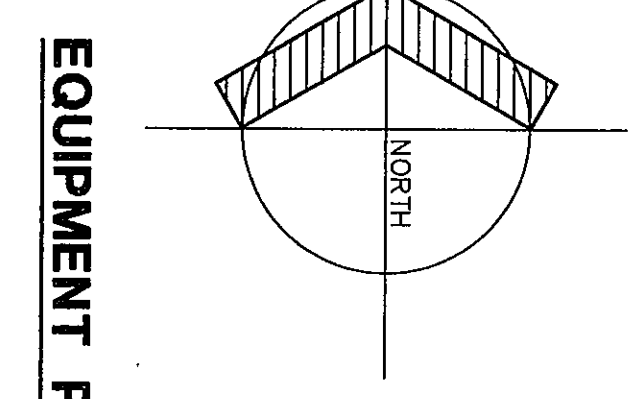

EQUIPMENT PLAN UNIT "P1"

1/8" = 1'-0"

97-A-126