

ROOM LEGEND "A2"

ROOM NO.	ROOM NAME	AREA S.F.	CEILING HEIGHT
A201	CORRIDOR	1452	VARIABLE
A202	CLASSROOM	960	VARIABLE
A203	CLASSROOM	902	VARIABLE
A204	CLASSROOM	902	VARIABLE
A205	CLASSROOM	902	VARIABLE
A206	CLASSROOM	902	VARIABLE
A207	CLASSROOM	902	VARIABLE
A208	CLASSROOM	902	VARIABLE
A209	CLASSROOM	902	VARIABLE
A210	CLASSROOM	902	VARIABLE
A211	CLASSROOM	902	VARIABLE
A212	CLASSROOM	902	VARIABLE
A213	CLASSROOM	902	VARIABLE
A214	CLASSROOM	902	VARIABLE
A215	CLASSROOM	902	VARIABLE
A216	CLASSROOM	902	VARIABLE
A217	CLASSROOM	902	VARIABLE
A218	CLASSROOM	902	VARIABLE
A219	CLASSROOM	902	VARIABLE
A220	CLASSROOM	902	VARIABLE
A221	CLASSROOM	902	VARIABLE
A222	CLASSROOM	902	VARIABLE

EQUIPMENT PLAN GENERAL NOTES

- INDICATES SCHEDULED RESIDENTIAL AND SECURITY CASEWORK. REFER TO SPECIFICATION SECTION 11450 FOR SCHEDULE.
- INDICATES SCHEDULED DIAGNOSIS CASEWORK. REFER TO SPECIFICATION SECTION 11470 FOR SCHEDULE.
- INDICATES SCHEDULED PHYSICAL EDUCATION CASEWORK. REFER TO SPECIFICATION SECTION 11480 FOR SCHEDULE.
- INDICATES SCHEDULED MEDIA CENTER CASEWORK. REFER TO SPECIFICATION SECTION 12315 FOR SCHEDULE.
- INDICATES SCHEDULED EDUCATIONAL CASEWORK. REFER TO SPECIFICATION SECTION 12324 FOR SCHEDULE.
- INDICATES SCHEDULED SCIENCE CASEWORK. REFER TO SPECIFICATION SECTION 12345 FOR SCHEDULE.
- INDICATES SCHEDULED MUSIC CASEWORK. REFER TO SPECIFICATION SECTION 12324 FOR SCHEDULE.
- COUNTERTOPS SHALL BE PROVIDED WITH A 4" HIGH BACKSPLASH AND ENDSPASH EXCEPT WHEN DETAILED OTHERWISE. PROVIDE FLUERS AS REQUIRED BETWEEN CASEWORK UNITS AND OTHER WALL UNITS AND WALL.
- PROVIDE CONTINUOUS COUNTERTOPS.
- ALL EXPOSED ENDS AND BACKS SHALL BE FINISHED.
- THE CABINET INSTALLER SHALL CALLK BETWEEN COUNTERTOPS AND BACKSPLASHES, ENDSPASHES AND WALLS.
- THE CABINET INSTALLER SHALL CUT CASEWORK UNITS AS REQUIRED FOR WALLS/ELECTRICAL UNITS AND CABINET-INSTALLED EQUIPMENT.
- ALL WALL-MOUNTED CASEWORK SHALL BE MOUNTED WITH THE TOP @ 7'-0" A.F.F. UNLESS NOTED OTHERWISE. SEE SHEET A7.28 FOR MOUNTING HEIGHTS.
- ALL CASEWORK DOORS AND DRAWERS SHALL BE LOCKABLE - KEYS PER ROOM UNLESS NOTED OTHERWISE.
- CABINETS UNITS TO RECEIVE SINKS SHALL BE CONSTRUCTED TO ALLOW FOR INSTALLATION OF SINKS FOR SIZES INDICATED. COORDINATE WITH DIVISION 15 FOR SINK SIZES.
- PROVIDE A FINISHED TOP ON ALL CABINETS THAT DO NOT HAVE A BULKHEAD ABOVE THEM.
- PROVIDE ABOVE ALL WALL CABINETS BELOW BULKHEADS CLOSURE PIECE. REFER TO DETAIL 3-A7.28.
- REFER TO DETAIL 4-A7.28 FOR WALL CABINET CONSTRUCTION. VERIFY LOCATION OF TV MONITOR IN CLASSROOMS IF ALTERNATIVE FOR THE SLOPED PROJECTION SCREEN IS NOT ACCEPTED.

LOCKER LEGEND

- 12" X 12" X 60" STANDARD LOCKERS
REFER TO DETAIL 9-A7.29 & SPEC. SECT. 10500.
- 12" X 12" X 72" STANDARD LOCKERS
WITH SLOPED TOPS - REFER TO DETAIL 3-A7.30 & SPEC. SECT. 10500.
- 12" X 12" X 60" ATHLETIC LOCKERS
WITH SLOPED TOPS - REFER TO DETAIL 1-A7.30 & 2-A7.30 AND SPEC. SECTION 10505.
- 12" X 12" X 12" 5 TIER HIGH ATHLETIC LOCKERS
WITH SLOPED TOPS - REFER TO DETAIL 1-A7.30 AND 2-A7.30 AND SPEC. SECTION 10505.
- 24" X 18" X 72" ATHLETIC LOCKERS
WITH SLOPED TOPS - REFER TO DETAIL 1-A7.30 & SPEC. SECT. 10505.
- 24" X 21" X 72" ATHLETIC LOCKERS
WITH SLOPED TOPS - REFER TO DETAIL 3-A7.30 & SPEC. SECT. 10505.

PROVIDE LOCKERS FOR THE PHYSICALLY CHALLENGED PER SPEC. SECTION 10500.

CASEWORK NOTES

- OPERABLE WALL, MODEL 932 - REFER TO SPEC. SECT. 10505. REFER TO ROOM A202.
- 30"H. COUNTERTOP - PROVIDE IN COUNTERTOP A HOLE FOR A 24"DIA. (CLEAR INSIDE DIA.) DRAINLET - REFER TO ROOM A211.
- PROVIDE (1) COAT HOOK ON WALL BEHIND DOOR IN ROOMS A212 & 213. REFER TO SPEC. SECTION 10900.
- PROVIDE THIS CASEWORK AS AN ALTERNATE. REFER TO ALTERNATIVES.
- PROVIDE MONITOR CABINET (DETAIL 16-A7.29) IN CLASSROOM, WHERE INDICATED. ADJUST VISUAL DISPLAY BOARDS ACCORDINGLY. REFER TO ALTERNATIVES. REFER TO ELECTRICAL DRAWINGS FOR LOCATION OF COMPUTER HUB. MODIFY CASEWORK ACCORDINGLY.

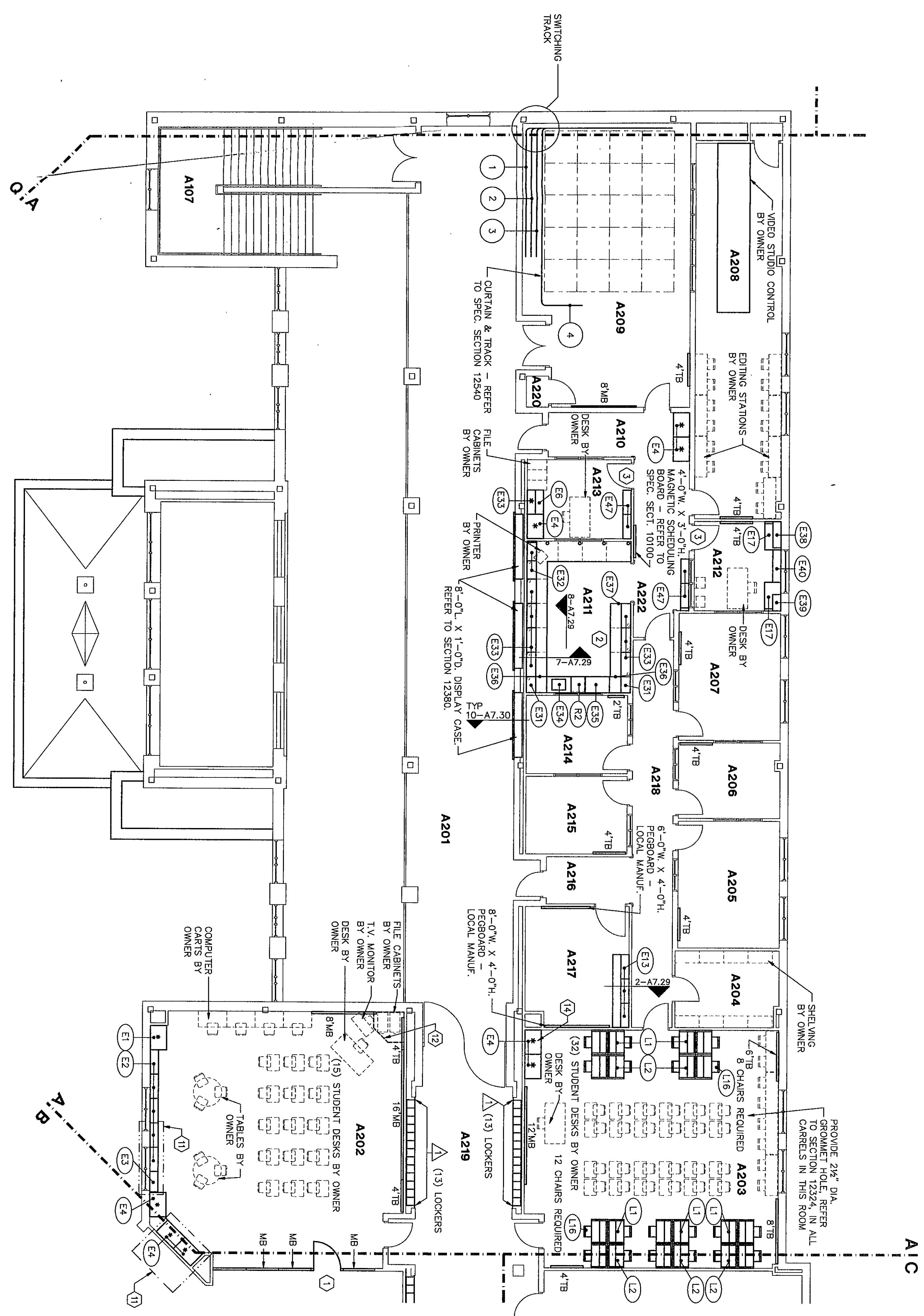

TV/STUDIO CURTAIN SCHEDULE

ITEM NO.	DESCRIPTION	CURTAIN SIZE	CURTAIN MATERIAL	TRACK SIZE	SUSPENSION
1	CURTAIN #1	42'-0" L. X 12'-0" H.	MARVEL VELVET	#142 TRACK (SEE PLAN POSITION)	DEAD HUNG
2	CURTAIN #1	42'-0" L. X 12'-0" H.	MARVEL VELVET	#142 TRACK (SEE PLAN POSITION)	DEAD HUNG
3	CURTAIN #1	42'-0" L. X 12'-0" H.	MARVEL VELVET	#142 TRACK (SEE PLAN POSITION)	DEAD HUNG
4				#142 TRACK (SEE PLAN POSITION)	DEAD HUNG

EQUIPMENT PLAN UNIT "A2"

8" = 1'-0"

07-K-106